

**CONTACT INFORMATION**

- Website: [www.supermicro.com](http://www.supermicro.com)
- General Information: [marketing@supermicro.com](mailto:marketing@supermicro.com)
- Technical Support: [support@supermicro.com](mailto:support@supermicro.com)
- Phone: +1 (408) 503-8000, Fax: +1 (408) 503-8008

**FOR YOUR SYSTEM TO WORK PROPERLY, PLEASE DOWNLOAD APPROPRIATE**

**DRIVERS/IMAGES/USER'S MANUAL FROM THE LINKS BELOW:**

- Manuals: <http://www.supermicro.com/support/manuals>
- Drivers & Utilities: [ftp://ftp.supermicro.com/CDR\\_Images/CDR-A1-UP/](ftp://ftp.supermicro.com/CDR_Images/CDR-A1-UP/)
- Safety: [http://www.supermicro.com/about/policies/safety\\_information.cfm](http://www.supermicro.com/about/policies/safety_information.cfm)

**Motherboard Layout and Features**

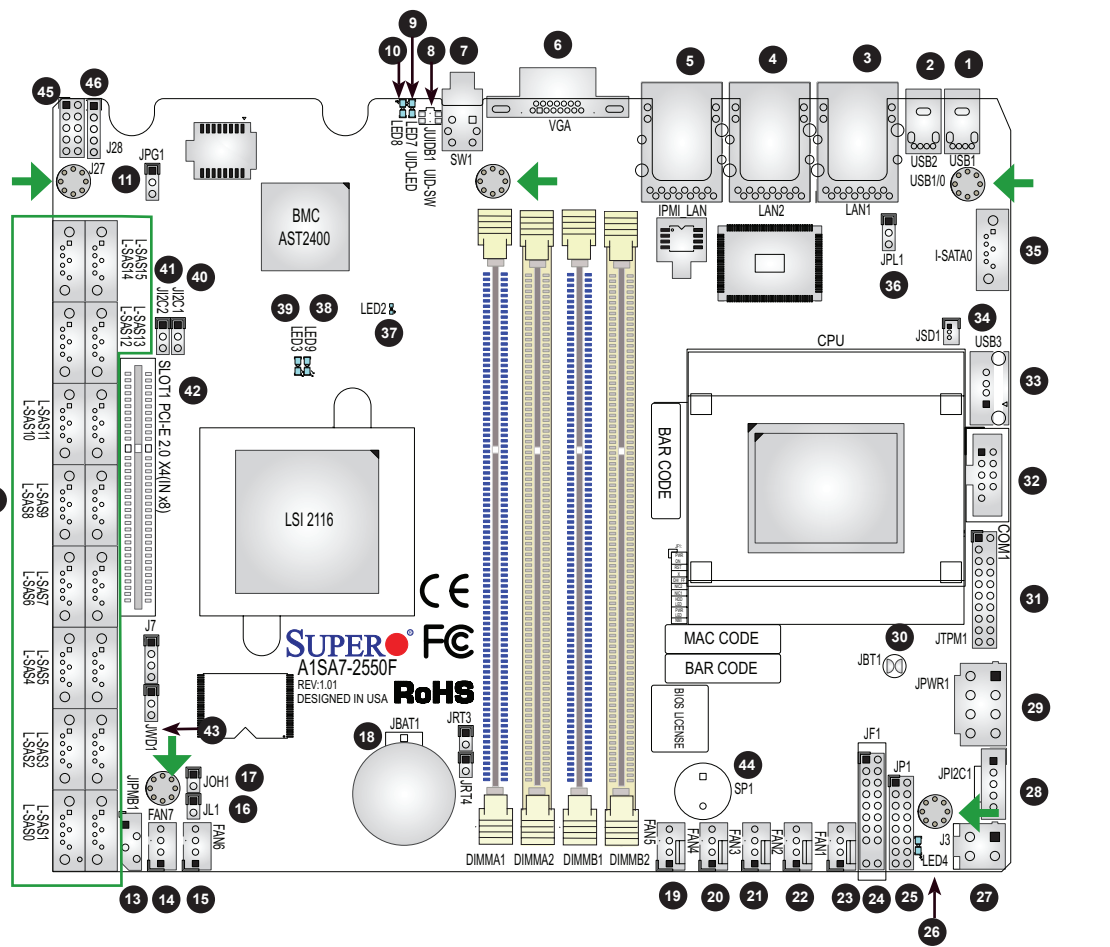

→ = mounting hole ⚡ Note: Item numbers are in counterclockwise order

**Front Panel Control (JF1)**

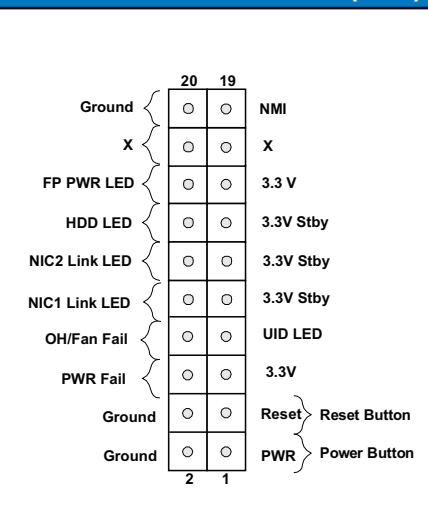

Note: Graphics shown in this quick reference guide are for illustration only. Your components may or may not look exactly the same as drawings shown in this guide.

**Back Panel I/O Connectors**

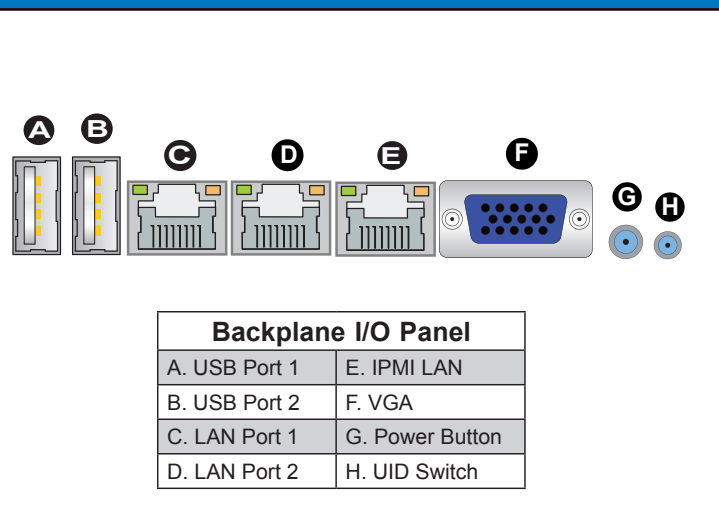

Note: Graphics shown in this quick reference guide are for illustration only. Your components may or may not look exactly the same as drawings shown in this guide.

**Jumpers, Connectors and LED Indicators**

Jumpers			
Jumper	Item #	Description	Default
JBT1	30	CMOS Clear	Open: Normal Operation, Short: Clear CMOS
J1°C1/J1°C2	40, 41	SMB to PCI-Exp. Slots	Off (Disabled)
JPG1	11	VGA Enable	Pins 1-2 (Enabled)
JPL1	36	Ethernet LAN Ports Enable	Pins 1-2 (Enabled)
JWD1	43	Watch Dog Enable	Pins 1-2 (Reset)

Connectors		
Connector	Item #	Description
Battery (JBAT1)	18	Onboard Battery
COM1	32	COM1 Header
FAN1-FAN7	23, 22, 21, 20 19, 14, 15	CPU/System Cooling Fans
IPMI_LAN	5	IPMI Dedicated LAN
J3	27	Motherboard 5V Standby Power Input
JF1	24	Front Panel Control Header
JIPMB1	13	4-pin External SMBus I²C Header (for an IPMI Card)
JL1	16	Chassis Intrusion Header
JOH1	17	Overheat/Fan Fail LED Header
JP1	25	HDD Backplane Power Control header
JPI²C1	28	Power Supply System Management Bus (SMBus) I²C Header
JPWR1	29	+12V 8-pin Motherboard Power connector
JSD1	34	SATA DOM (Device_On_Module) Power Connector
JTPM1	31	Trusted Platform Module (TPM)/Port 80 Connector
JUIDB1	8	Unit Identifier (UID) Button
LAN1/LAN2	3, 4	Gigabit Ethernet (RJ45) Ports
L-SAS0 - L-SAS15	12	LSI 2116 SAS Ports 0-15
I-SATA0	35	Intel Serial ATA Port 0
PCI-E Slot	42	PCI-E Slot 2.0 x4 (x8)
SP1	44	Internal Speaker/Buzzer
SW1	7	Power Button
USB1/USB2	1, 2	Backpanel USB 2.0 Ports 1/2
USB 3	33	USB 2.0 Front Access Support/Type A Connector
VGA	6	Backpanel VGA Port
J27	45	NC-SI header for AOC-STGN-i1SF 10GbE card
J28	46	Power to AOC-STGN-i1SF 10GbE card

LED Indicators				
LED	Item #	Description	Color/State	Status
LED2	37	BMC Heartbeat LED	Green: Blinking	BMC: Normal
LED3	39	LSISAS2116 Heartbeat LED	Green: Blinking	SAS Controller: Normal
LED4	26	Power LED	Green: On	System Power On
LED7	9	UID Switch LED	Blue: On	Unit Identified
LED8	10	Overheat/PWR Fail/Fan Fail LED	Red: Solid on/Blinking	Solid On: Overheat, Blinking: PWR Fail or Fan Fail
LED9	38	LSISA2116 Error LED	Red: On	LSISAS2116 Error Status

Note: Refer to Chapter 1 of the User Manual for detailed information on jumpers, connectors, and LED indicators.

**Memory Support**

The A1SA7-2750/2550F motherboard supports up to 64GB of DDR3 ECC or Non-ECC Unbuffered (UDIMM) 1600/1333 MHz in x8 data width only, in 4 memory slots. Populating these DIMM modules with a pair of memory modules of the same type and same size will result in better memory performance.

**DIMM Memory Installation**

↑ Towards the edge of motherboard

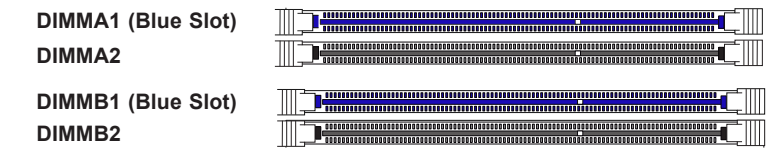

**Memory Population Guidelines**

When installing memory modules, the DIMM slots should be populated in the following order: DIMMA1, DIMMB1, then DIMMA2, DIMMB2.

- Always use DDR3 DIMM modules of the same size, type and speed.
- The motherboard will support one DIMM module or three DIMM modules installed. However for best memory performance, install DIMM modules in pairs.
- Be sure to use memory modules of the same type, same speed, and same frequency on the same motherboard. Mixing of memory modules of different types and speeds is not allowed.

**Recommended Population (Balanced)**

DIMMA1 Slot	DIMMB1 Slot	DIMMA2 Slot	DIMMB2 Slot	Total System Memory
4GB	4GB			8GB
4GB	4GB	4GB	4GB	16GB
8GB	8GB			16GB
8GB	8GB	8GB	8GB	32GB

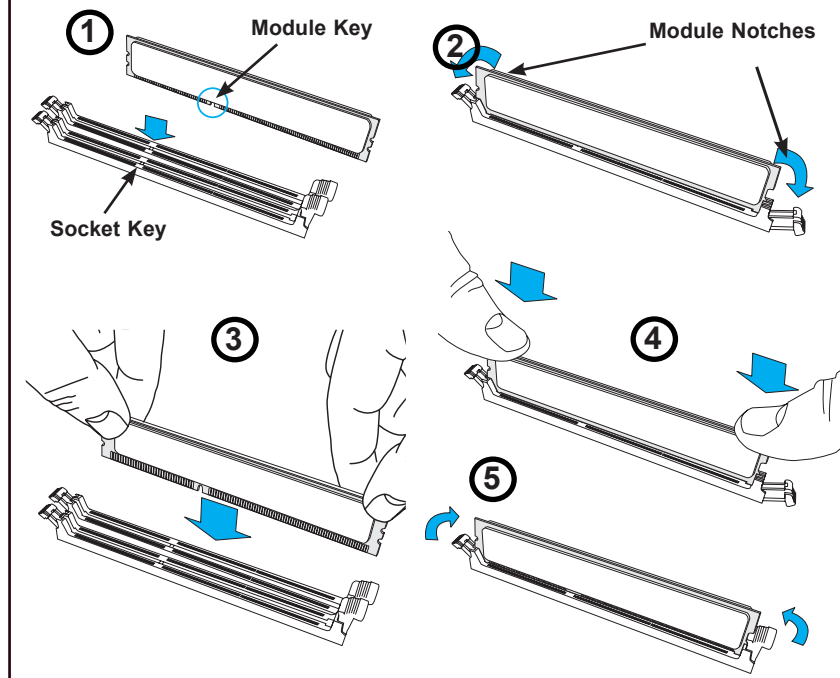

Note: Refer to Chapter 2 of the User Manual for detailed information on memory support and CPU/motherboard installation instructions.