

Motherboard Layout and Features

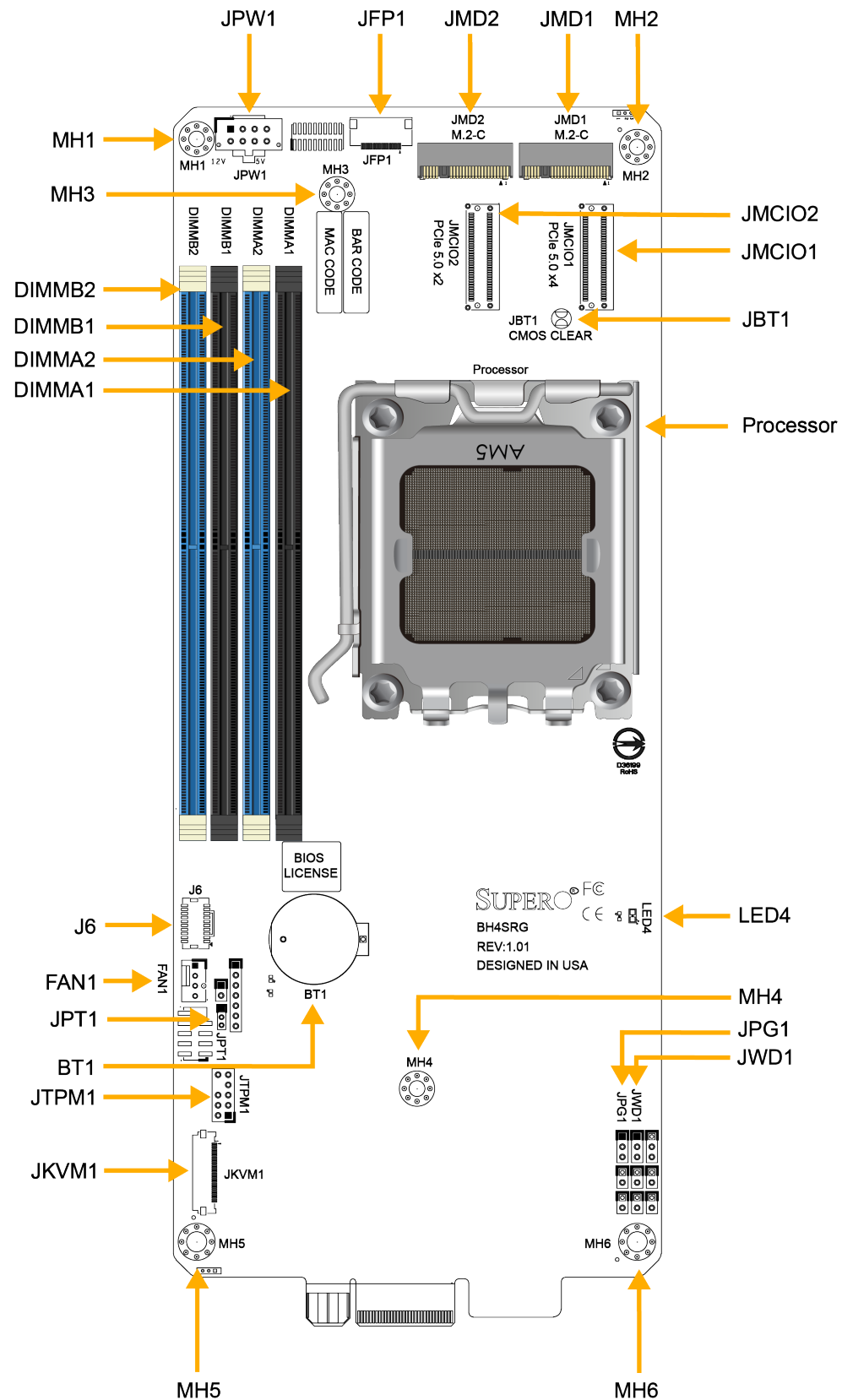

Jumpers, Connectors, and an LED Indicator

Jumpers		
Jumper	Description	Default Setting
JBT1	CMOS Clear	Open (Normal)
JPG1	VGA Enable/Disable	Pins 1-2 (Enabled)
JPT1	Onboard TPM 2.0 Enable/Disable	Pins 1-2 (Enabled)
JWD1	Watchdog Timer	Pins 1-2 (Reset)

Connectors	
Connector	Description
FAN1	System Cooling Fan Header
J6	Power Distributor Board Sideband Signal Header
JFP1	Front Control Panel Connector
JMD1	M.2 Slot 2280/22110 M-Key (PCIe 5.0 x4)
JMD2	M.2 Slot 2280/22110 M-Key (PCIe 5.0 x2)
JMCO1/JMCO2	MCIO PCIe 5.0 x8 Connectors
JPW1	8-pin +12 V/+5 V Power Connector
JTPM1	Trusted Platform Module
JKVM1	VGA/USB Module Connector

LED Indicator		
LED	Description	Status
LED4	BMC Heartbeat LED	Blinking Green: BMC Normal

Memory and Processor Support

Processor Support

Supports a single AMD EPYC™ 4004/4005 processor with a Thermal Design Power (TDP) of up to 170 W in an AM5 socket.

Memory Support

The BH4SRG motherboard supports up to 192 GB of ECC and Non-ECC DDR5 UDIMM memory with speeds of up to 5600 MT/s in two DIMM slots or up to 3600 MT/s in four DIMM slots.

Four DIMM Slots							
Channel	DIMM Slot	DIMM Configuration and Maximum Memory Speed (MT/s)					
		1	2	3	4	5	6
Channel A	DIMMA1					Up to 3600 MT/s	Up to 3600 MT/s
	DIMMA2	Up to 5600 MT/s		Up to 5600 MT/s		Up to 3600 MT/s	Up to 3600 MT/s
Channel B	DIMMB1				Up to 3600 MT/s		Up to 3600 MT/s
	DIMMB2		Up to 5600 MT/s	Up to 5600 MT/s	Up to 3600 MT/s		Up to 3600 MT/s

Processor Installation

The BH4SRG motherboard supports a single AMD EPYC™ 4004/4005 processor with a Thermal Design Power (TDP) of up to 170 W in an AM5 socket.

Note: Do not remove the plastic cover covering the outside of the socket. This cover will pop out during the installation of the processor.

- 1 Use a finger to push down the lever, then move the lever rightward. Pull the lever until it passes over the processor socket.

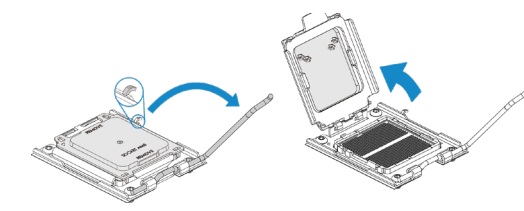

- 2 Pick up the processor on its left and right edges. Hold the processor over the socket and align the arrow on the top-left corner of the processor with the arrow on the top-left corner of the socket. Gently lower it onto the AM5 socket pins.

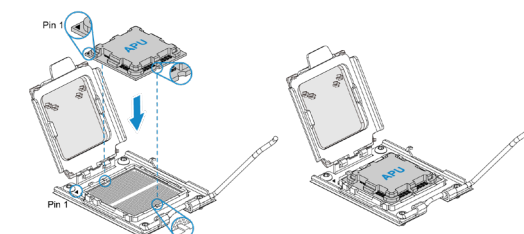

- 3 With the processor in the socket, lower the socket force frame.

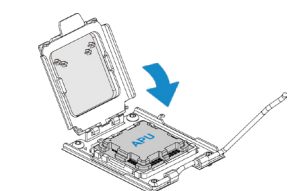

- 4 Reattach the lever arm onto the right side of the socket. The outer plastic cover will pop out when the lever arm is reattached.

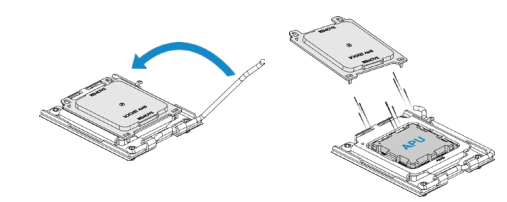

- 5 When finished, the socket force frame will secure the processor.

