

Motherboard Layout and Features

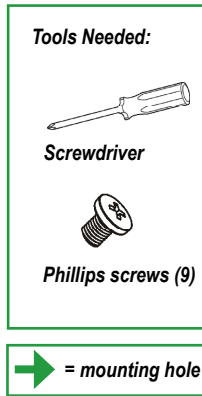

 Note: Graphics shown in this quick reference guide are for illustration only. Your components may or may not look exactly the same as drawings shown in this guide.

Jumpers, Connectors and LED Indicators

Jumpers		
Jumper	Description	Default
JBT1	CMOS Clear	(See Chpt. 2)
JPG1	VGA Enable	Pins 1-2 (Enabled)
JPME1	ME Recovery	Pins 1-2 (Normal)
JPME2	Manufacture Mode Select	Pins 1-2 (Normal)
JWD1	Watch Dog Timer Enable	Pins 1-2 (RST)

Connectors	
Connector	Description
Battery	Onboard Battery
IPMI_LAN	IPMI_Dedicated LAN
JKVM1	USB (x2)/VGA (Monitor)/COM (UART) Connector for Remote Console Redirection or Remote Network Interface
JP16	Power Output for Hard Disk Drive (12V and 5V)
JP17	Motherboard Interface to PDB
JP18	Motherboard Interface to PDB
JPWR2	SMC-Proprietary Power Connector
JSD1	SATA DOM (Device_On_Module) Power Connector
JTPM1	Trusted Platform Module/Port 80 Connector
I-SATA0 - I-SATA4	(Intel PCH) Serial ATA Ports 0-4 (I-SATA0-3: SATA 3.0 Ports, I-SATA4: SATA 2.0 Port)
Micro-LP PCI-E Slot	SMC-Proprietary Micro Low-Profile (LP) PCI-Express 3.0 x8 Slot
SW1	Power Switch/LED Indicator
UID	Unit Identifier (UID) Button (JUIDB)
USB2, USB3 (3.0)	Internal Type A USB 3.0

LED Indicators			
LED	Description	Color/State	Status
LE5	BMC Heartbeat LED	Green: Blinking	BMC Functions Normally
LED5	Power Fail/Fan Fail/Overheat	Red: On	Power Fail, Fan Fail or Overheating
LED6	UID LED	Blue: On	Unit Identified

CPU Installation

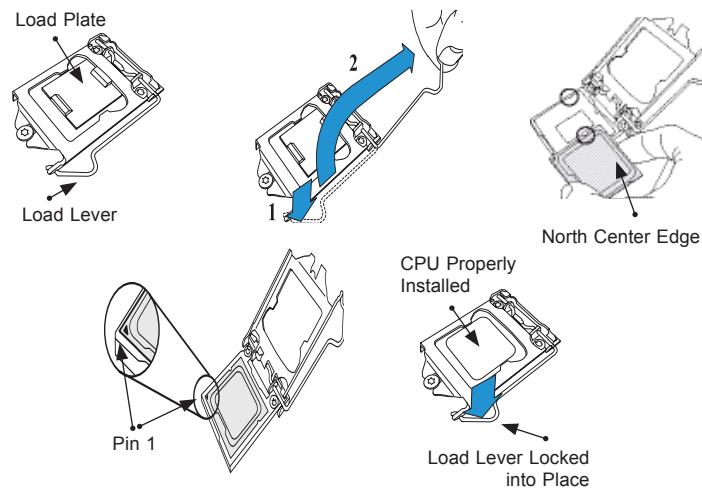

 **Note:** Refer to Chapter 2 of the User Manual for detailed information on memory support and CPU/motherboard installation instructions.

Memory Support

The X10SLE-F/-HF supports up to 32GB of Unbuffered (UDIMM) DDR3 ECC 1600/1333/1066 MHz VLP (Very Low Profile) memory in 4 slots.

DIMM Memory Installation

Memory Population Guidelines

Please follow the table below when populating the X10SLE-F/HF.

Recommended Population (Balanced)				
DIMMA2	DIMMB2	DIMMA1	DIMMB1	Total System Memory
2GB DIMM	2GB DIMM			4GB
2GB DIMM	2GB DIMM	2GB DIMM	2GB DIMM	8GB
4GB DIMM	4GB DIMM			8GB
4GB DIMM	4GB DIMM	4GB DIMM	4GB DIMM	16GB
8GB DIMM	8GB DIMM			16GB
8GB DIMM	8GB DIMM	8GB DIMM	8GB DIMM	32GB

Insert the desired number of DIMMs into the memory slots, starting with DIMMA2 (Channel A, Slot 2). For the system to work properly, please use the memory modules of the same type and speed in the same motherboard.

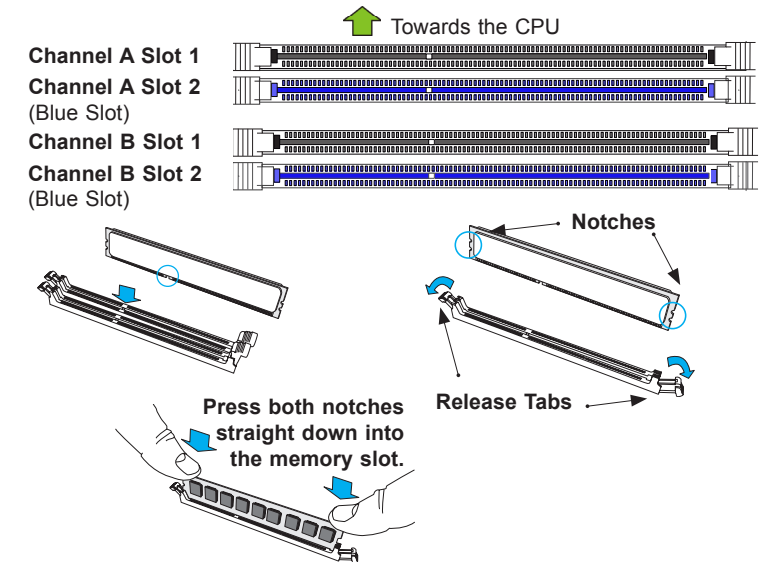

Heatsink Installation

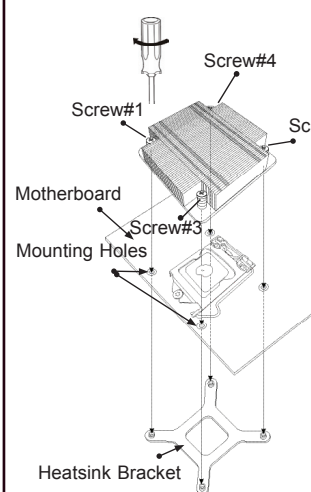

IPMI LAN Port LED

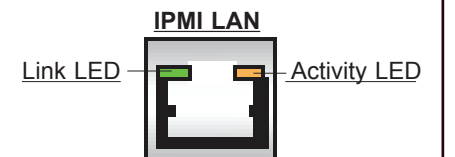

IPMI LAN Link LED (Left) & Activity LED (Right)		
	Color/State	Definition
Link (Left)	Green: Solid	100 Mbps
	Amber: Solid	1000 Mbps
Activity (Right)	Yellow Blinking	Active

 **Note:** Refer to Chapter 1 of the User Manual for detailed information on jumpers, connectors, and LED indicators.