

SUPERMICR®
X11SSA-F / X11SSi-LN4F
Quick Reference Guide 1.0c

CONTACT INFORMATION

- Website: www.supermicro.com
- General Information: marketing@supermicro.com
- Technical Support: support@supermicro.com
- Phone: +1 (408) 503-8000, Fax: +1 (408) 503-8008

FOR YOUR SYSTEM TO WORK PROPERLY, PLEASE DOWNLOAD APPROPRIATE

DRIVERS/IMAGES/USER'S MANUAL FROM THE LINKS BELOW:

- Manuals: <http://www.supermicro.com/support/manuals>
- Drivers & Utilities: <https://www.supermicro.com/wftp/driver>
- Safety: http://www.supermicro.com/about/policies/safety_information.cfm

PACKAGE CONTENTS

- One (1) Supermicro Motherboard
- Six (6) SATA Cables
- One (1) I/O Shield
- One (1) Quick Reference Guide



WARNING: This product can expose you to chemicals including lead, known to the State of California to cause cancer and birth defects or other reproductive harm. For more information, go to www.P65Warnings.ca.gov.

Motherboard Layout and Features

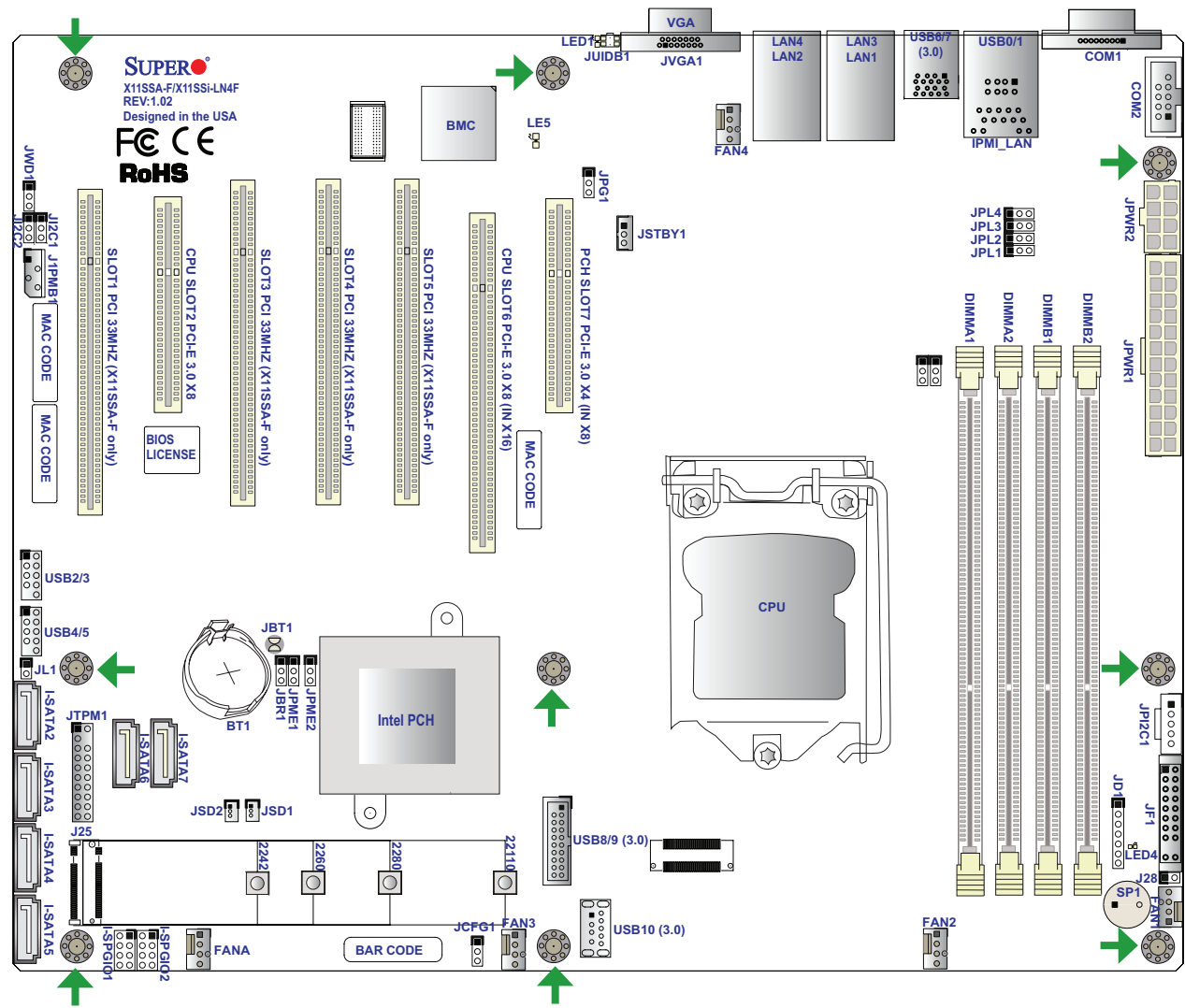

CPU Installation

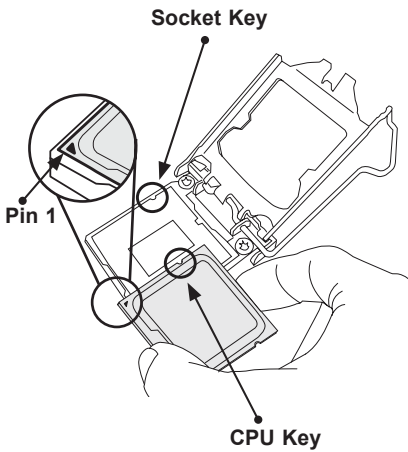

Heatsink Installation

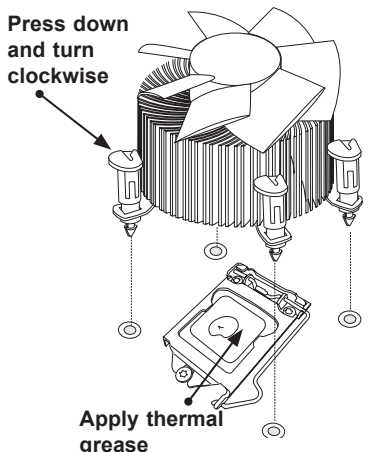

Front Control Panel (JF1)

Power Button	PWR	1	2	Ground
Reset Button	Reset	3	4	Ground
3.3 V		5	6	Power Fail LED
Red+ (Blue LED Cathode)		7	8	Blue+ (OH/Fan Fail/ PWR Fail/UID LED)
NIC2 Active LED		9	10	NIC2 Link LED
NIC1 Active LED		11	12	NIC1 Link LED
ID_UID_SW/3.3V Stdbyp		13	14	HDD LED
3.3V		15	16	FP PWRLED
X		17	18	X
NMI		19	20	Ground

Jumpers and Connectors

Jumpers		
Jumper	Description	Default
JBR1	BIOS Recovery	Pins 1-2 (Normal)
JBT1	CMOS Clear	Open (Normal)
JIC1/JIC2	SMB to PCI Slots (X11SSA-F only)	Pins 2-3 (Disabled)
JPG1	VGA Enable	Pins 1-2 (Enabled)
JPL1-JPL4	LAN1-LAN4 Enable (LAN3/LAN4 for X11SSi-LN4F only)	Pins 1-2 (Enabled)
JPME1	ME Recovery	Pins 1-2 (Normal)
JPME2	Manufacturing Mode	Pins 1-2 (Normal)
JWD1	Watch Dog Enable	Pins 1-2 (Reset)

Connectors	
BT1	Onboard Battery
COM1/COM2	COM1/COM2 Port Headers
FAN1-FAN4, FANA	System/CPU Fan Headers
IPMI_LAN	Dedicated IPMI Gigabit (RJ45) Port
I-SATA2-I-SATA7	SATA 3.0 Connectors via Intel PCH (6Gb/s)
I-SGPIO1/I-SGPIO2	Serial Link General Purpose I/O (SGPIO) Headers for I-SATA 3.0 connections (I-SGPIO1 for I-SATA0-3, I-SGPIO2 for I-SATA4-7)
J25	M.2 Socket 3 (supports 2242, 2260, 2280, 22110 for NVMe and SATA SSD)
J28	Front Panel LED jumper for LAN3 and LAN4 (X11SSi-LN4F only)
JCFG1	(For internal debugging only)
JD1	Speaker/Power LED Indicator
JF1	Front Control Panel Header
JIPMB1	4-pin External BMC I ² C Header (for an IPMI Card)
JL1	Chassis Intrusion Header
JPI ² C1	Power I ² C System Management Bus (Power SMB) Header
JPWR1	24-pin ATX Main Power Connector (Required)
JPWR2	+12V 8-pin CPU Power Connector (Required)
JSD1/JSD2	SATA Disk On Module (DOM) Power Connectors
JSTBY1	Standby Power Header
JTPM1	Trusted Platform Module (TPM)/Port 80 Connector
JUIDB1	Unit Identifier (UID) Switch
LAN1-LAN4	Gigabit (RJ45) LAN Ports (LAN3/LAN4: for X11SSi-LN4F only)
PCI Slot 1, Slots 3-5	Legacy PCI-32 Slots (5V) (for X11SSA-F only)
PCI (CPU) Slot 2	PCI-Express 3.0 x8 Slot
PCI (CPU) Slot6	PCI-Express 3.0 x8 in x16 Slot
PCI (PCH) Slot 7	PCI-Express 3.0 x4 in x8 Slot
SP1	Internal Speaker/Buzzer
USB 0/1	Back Panel USB 2.0 Ports
USB 2/3	USB 2.0 Header
USB 4/5	USB 2.0 Header
USB 6/7	Back Panel USB 3.0 Ports
USB 8/9	Front Accessible USB 3.0 Header
USB 10	USB 3.0 Type-A Header
VGA	Back Panel VGA Port

Note: Refer to Chapter 1 of the User Manual for detailed information on jumpers, connectors, and LED indicators.

LED Indicators

LED Indicators			
LED	Description	Color/State	Status
LE5	BMC Heartbeat LED	Green: Blinking	BMC Normal
LED1	Rear UID LED	Blue: On	Unit Identified
LED4	Onboard Power LED	Green: Solid On	Power On

CPU Support

The X11SSA-F / X11SSi-LN4F supports an Intel Xeon E3-1200 v6/v5, 7th/6th Gen Core i3, Pentium, and Celeron series processor in an LGA1151 type socket.

Memory Support

The X11SSA-F / X11SSi-LN4F motherboard supports up to 64GB of DDR4 ECC UDIMM memory at a speed of up to 2400MHz in four memory slots. Populating these DIMM slots with a pair of memory modules of the same type and size will result in interleaved memory, which will improve memory performance.

DIMM Memory Installation

When installing memory modules, the DIMM slots should be populated in the following order: DIMMB2, DIMMA2, then DIMMB1, DIMMA1. Populate the blue slots first.

- Always use DDR4 DIMM modules of the same type, size, and speed. Mixed DIMM speeds can be installed. However, all DIMMs will run at the speed of the slowest DIMM.
- The motherboard will support odd-numbered modules (1 or 3 modules installed). However, for best memory performance, install DIMM modules in pairs to activate memory interleaving.

Recommended Population (Balanced)

DIMMA1	DIMMB1	DIMMA2	DIMMB2	Total System Memory
		2GB	2GB	4GB
2GB	2GB	2GB	2GB	8GB
		4GB	4GB	8GB
4GB	4GB	4GB	4GB	16GB
		8GB	8GB	16GB
8GB	8GB	8GB	8GB	32GB
		16GB	16GB	32GB
16GB	16GB	16GB	16GB	64GB

Back Panel I/O Connectors

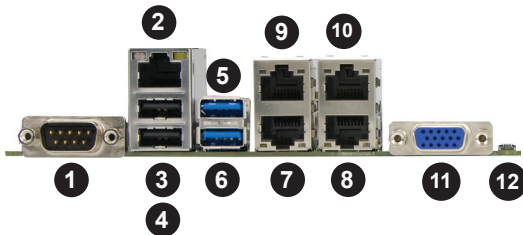

#	Description	#	Description	#	Description
1	COM 1	5	USB7 (3.0)	9	LAN3 (X11SSi-LN4F only)
2	Dedicated IPMI LAN	6	USB6 (3.0)	10	LAN4 (X11SSi-LN4F only)
3	USB1 (2.0)	7	G. LAN1	11	VGA Port
4	USB0 (2.0)	8	H. LAN2	12	UID Switch

Note: Refer to Chapter 2 of the User Manual for detailed information on memory support and CPU/motherboard installation instructions.

Note: Graphics shown in this quick reference guide are for illustration only. Your components may or may not look exactly the same as drawings shown in this guide.

MNL-1777-QRG-10c

© 2018 Supermicro Computer Inc. All rights reserved. Reproduction of this document whether in part or in whole is strictly prohibited without Supermicro's written consent. All trademarks are property of their respective entities. All information provided is deemed accurate at the time of printing, however, it is not guaranteed.