

CONTACT INFORMATION

- Website: www.supermicro.com
- General Information: marketing@supermicro.com
- Technical Support: support@supermicro.com
- Phone: +1 (408) 503-8000, Fax: +1 (408) 503-8008

FOR YOUR SYSTEM TO WORK PROPERLY, PLEASE DOWNLOAD APPROPRIATE DRIVERS/IMAGES/USER'S MANUAL FROM THE LINKS BELOW:

- Manuals: <http://www.supermicro.com/support/manuals>
- Drivers & Utilities: <https://www.supermicro.com/wdl/driver/>
- Safety: http://www.supermicro.com/about/policies/safety_information.cfm

PACKAGE CONTENTS

- One Supermicro Motherboard
- One Quick Reference Guide
- Two SATA Cables
- One I/O Shield



Motherboard Layout and Features

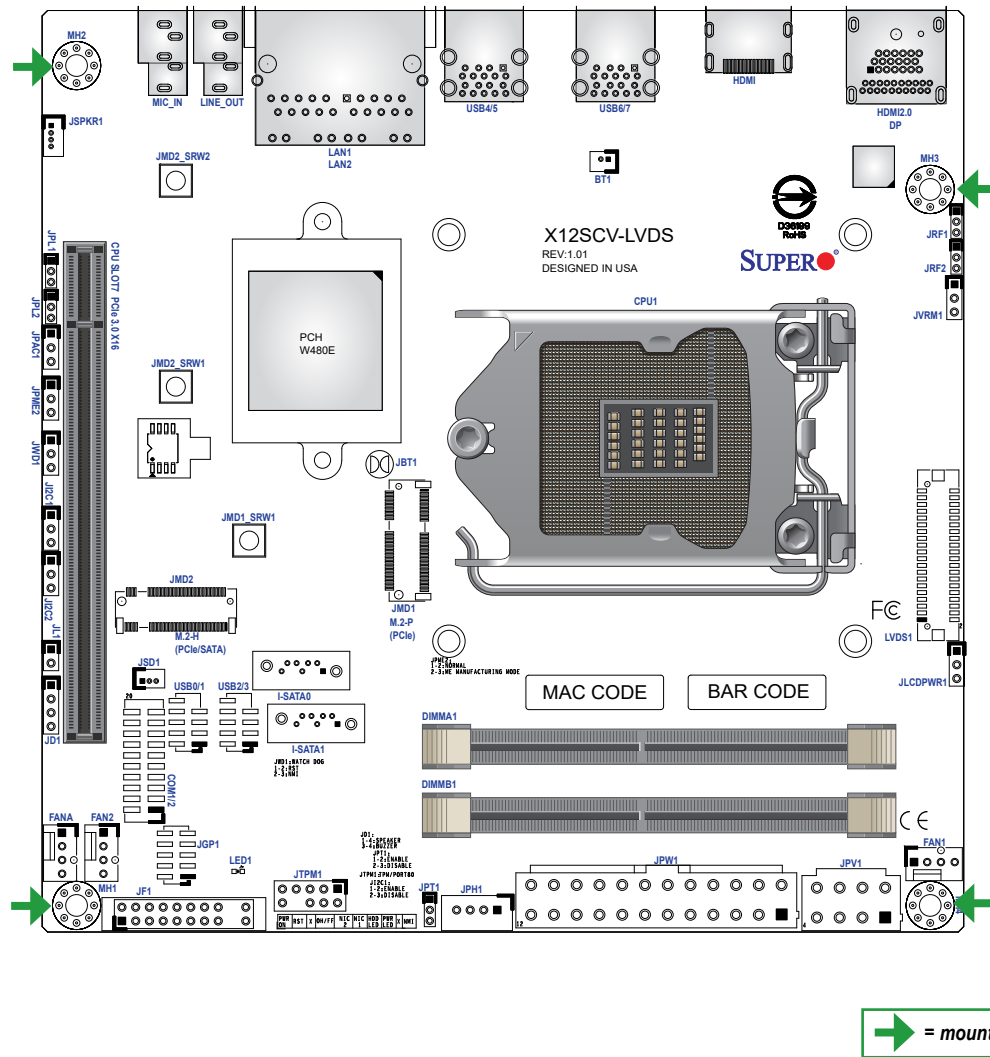

Jumpers, Connectors, and LED Indicators

Jumpers

Jumper	Description	Default Setting
JBT1	CMOS Clear	Open (Normal)
J1PC1, J1PC2	SMB to PCIe Slots Enable/Disable	Pins 2-3 (Disabled)
JLCDPWR1	LVDS Panel VCC Power +3.3/+5 V	Pins 1-2 (+3.3 V)
JPAC1	Audio Enable	Pins 1-2 (Enabled)
JPL1	LAN1 Enable/Disable	Pins 1-2 (Enabled)
JPL2	LAN2 Enable/Disable	Pins 1-2 (Enabled)
JPME2	Manufacturing Mode	Pins 1-2 (Normal)
JPT1	Onboard TPM Enable/Disable	Pins 2-3 (Disabled)
JRF1, JRF2	Slot7 PCIe Bifurcation	JRF1: Pins 1-2, 2-3 JRF2: Pins 1-2, 2-3 PEG: x16 (Default), x8x8, x8x4
JWD1	Watch Dog Timer	Pins 1-2 (Reset)

Connectors

Connector	Description
BT1	Extended CMOS Battery
COM1/2	COM Header
FAN1-FAN2, FANA	Fan Headers
HDMI 1.4	High Definition Multimedia Interface 1.4
HDMI 2.0, DP	High Definition Multimedia Interface 2.0, Display Port
I-SATA0, I-SATA1	SATA 3.0 Ports
JD1	Speaker Header (Pins 1-4: Speaker, Pins 3-4: Buzzer)
JF1	Front Control Panel Header
JGP1	General Purpose I/O Header
JL1	Chassis Intrusion Header
JMD1	M.2 E-Key 2230 (PCIe x1/USB2.0) Slot
JMD2	M.2 M-Key 2242/2280 (PCIe x4/SATA) Slot
JPH1	4-pin HDD Power Connector
JPV1	8-pin +12 V DC Power Connector for CPU (Required) or alternative single power input for when the 24-pin ATX power is not in use
JPW1	24-pin ATX Power Connector
JSD1	SATA DOM Power Connector
JSPKR1	Speaker Header (supporting up to 2 W)
JTPM1	Trusted Platform Module/Port 80 Connector
LAN1, LAN2	LAN Ports
LINE_OUT	HD Audio Line Out
LVDS1	Low Voltage Differential Signaling (LVDS) Connector
MIC_IN	HD Audio Mic In
MH1-MH4	Mounting Holes
SLOT7	CPU PCIe 3.0 x16 Slot
USB0/1, 2/3	Front Accessible USB 2.0 Headers
USB4/5, 6/7	Back Panel USB 3.2 Ports

LED Indicators

LED	Description	Status
LED1	Power LED	Solid Green: Power On Blinking Green: S3 Status

CPU Support

The X12SCV-LVDS supports Intel® W-1200 series and 10th Generation Core i9/i7/i5/i3 series processors up to 65 W in an LGA1200 socket.

Note: The X12SCV-LVDS does not support the Intel 10th/11th generation processor 2 M cache SKUs. These processors will not boot with the latest BIOS version.

Memory Support

The X12SCV-LVDS supports up to 64 GB of DDR4 2933 MT/s Non-ECC/ECC DDR4 SODIMM in two memory slots.

1. Insert SODIMM modules into slot DIMMA1 and then DIMMB1. Align the key on the bottom of the DIMM module against the receptive point on the memory slot. Take note of the notches on the side of the DIMM module and of the locking clips to avoid causing damage.

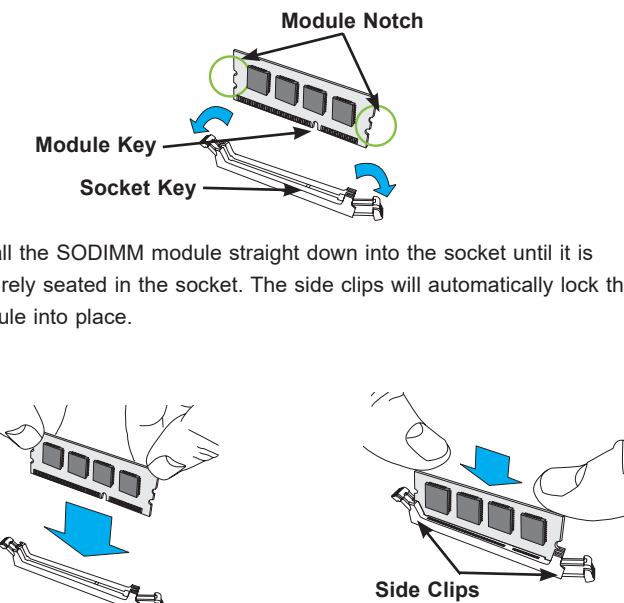

CPU Installation

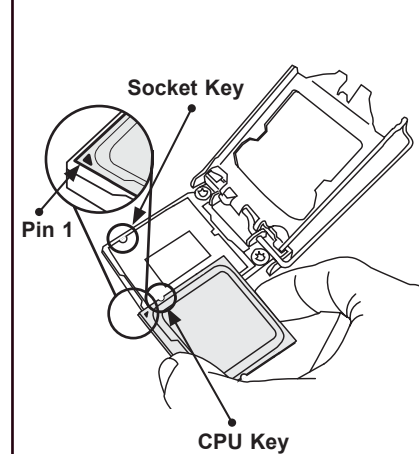

Heatsink Installation

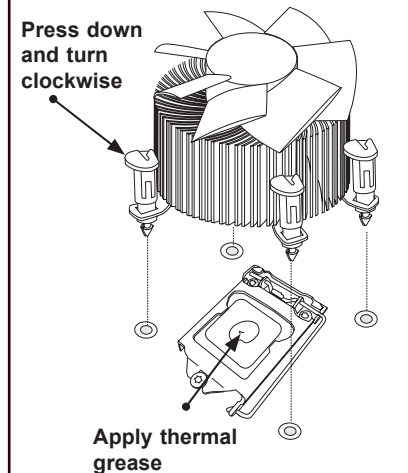

Front Control Panel

	1	2	
PWR	Power Button	○ ○	GND
Reset	Reset Button	○ ○	GND
	+3.3V	○ ○	X
	+3.3V Stby	○ ○	OH/Fan Fail LED
	+3.3V	○ ○	NIC2 Link LED
	+3.3V Stby	○ ○	NIC1 Link LED
	+3.3V	○ ○	HDD LED
	+3.3V Stby	○ ○	PWR LED
	X	○ ○	X
	NMI	○ ○	GND
		19 20	

Back Panel I/O Connectors

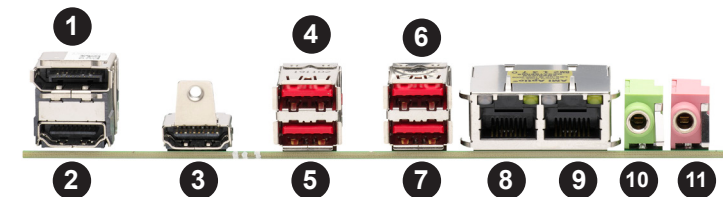

#	Description	#	Description	#	Description
1.	DisplayPort	5.	USB6 (3.2)	9.	LAN2
2.	HDMI 2.0	6.	USB5 (3.2)	10.	LINE_OUT
3.	HDMI 1.4	7.	USB4 (3.2)	11.	MIC_IN
4.	USB7 (3.2)	8.	LAN1		

Note: Graphics shown in this quick reference guide are for illustration only. Your components may or may not look exactly the same as drawings shown in this guide.

Note: Refer to Chapter 2 of the User Manual for detailed information on jumpers, connectors, and LED indicators.

Note: Refer to Chapter 2 of the User Manual for detailed information on memory support and CPU/motherboard installation instructions.