

CONTACT INFORMATION

- Website: www.supermicro.com
- General Information: marketing@supermicro.com
- Technical Support: support@supermicro.com
- Phone: +1 (408) 503-8000, Fax: +1 (408) 503-8008

FOR YOUR SYSTEM TO WORK PROPERLY, PLEASE DOWNLOAD APPROPRIATE

- DRIVERS/IMAGES/USER'S MANUAL FROM THE LINKS BELOW:**
- Manuals: <http://www.supermicro.com/support/manuals>
 - Drivers & Utilities: <https://www.supermicro.com/wdl/driver/>
 - Safety: http://www.supermicro.com/about/policies/safety_information.cfm

PACKAGE CONTENTS

- One Supermicro Motherboard
- One Quick Reference Guide
- One I/O Shield
- Six SATA Cables



WARNING: This product can expose you to chemicals including lead, known to the State of California to cause cancer and birth defects or other reproductive harm. For more information, go to www.P65Warnings.ca.gov.

Motherboard Layout and Features

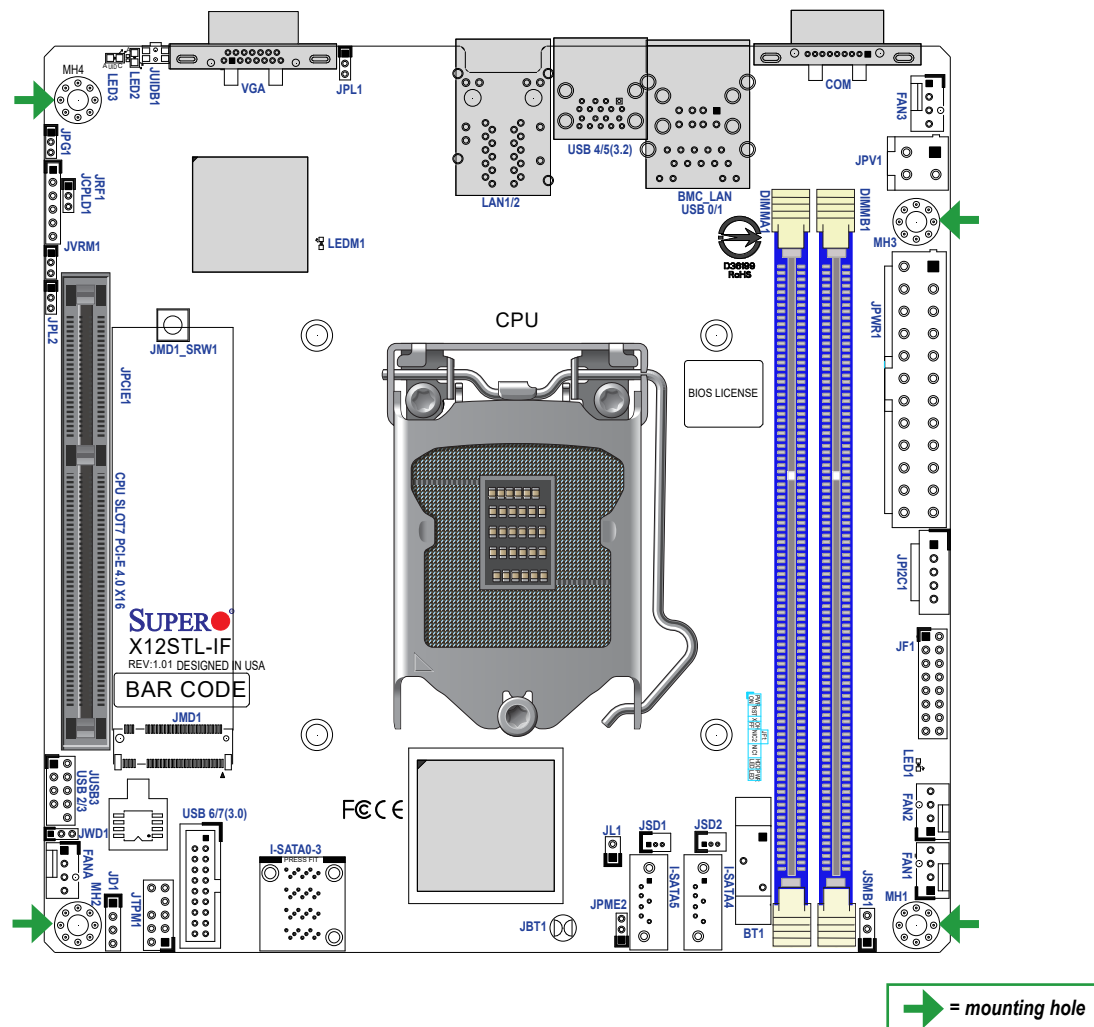

Jumpers and Connectors

Jumpers		
Jumper	Description	Default Setting
JBT1	CMOS Clear	Open (Normal)
JPG1	VGA Enable/Disable	Pins 1-2 (Enabled)
JPL1	LAN1 Enable/Disable	Pins 1-2 (Enabled)
JPL2	LAN2 Enable/Disable	Pins 1-2 (Enabled)
JPME2	Manufacturing Mode	Pins 1-2 (Normal)
JRF1	CPU PCIe Bifurcation	Pins 1-2 (JPCIE x16) Pins 2-3 (JPCIE 2 x8)
JWD1	Watch Dog Timer	Pins 1-2 (Reset)

Connectors	
Connector	Description
BMC_LAN	Dedicated BMC LAN Port
BT1	Onboard Battery
COM1	COM Port
FAN1 - FAN3, FANA	CPU/System Fan Headers (FAN1: CPU Fan)
I-SATA0-3	Intel® PCH SATA 3.0 Ports
I-SATA4, I-SATA5	Intel PCH SATA 3.0 Ports
JD1	Speaker/Buzzer
JF1	Front Control Panel Header
JL1	Chassis Intrusion Header
JMD1	M.2 PCIe 3.0 x4 (supports 2280 form factor)
JMD1_SRW1	M.2 Holding Screw
JPI2C1	Power I ² C System Management Bus (Power SMB) Header
JPWR1	24-pin ATX Power Connector (Required)
JPV1	4-pin HDD Power Connector
JSD1, JSD2	SATA DOM Power Connectors
JSMB1	System Management Bus Header
JTPM1	Trusted Platform Module (TPM)/Port 80 Connector
JUIDB1	UID Switch
LAN1/2	Gigabit Ethernet RJ45 Ports
MH1 - MH4	Mounting Holes
SLOT7	PCIe 4.0 x16 Slot (SLOT7 will run at PCIe 3.0 x16 when a Pentium processor is installed)
USB0/1	Back Panel USB 2.0 Ports
USB2/3	Front Accessible USB 2.0 Headers
USB4/5	Back Panel USB 3.2 Ports
USB6/7	Front Accessible USB 3.2 Headers
VGA	VGA Port

LED Indicators

LED Indicators		
LED	Description	Status
LED1	Onboard Power LED	Solid Green: Power On
LED2	UID LED	Solid Blue: Unit Identified
LED3	OH LED	Solid Red: Overheat
LEDM1	BMC Heartbeat LED	Blinking Green: Device Working

CPU Support

The X12STL-IF motherboard supports an Intel Xeon E-2300 and 10th Generation Pentium processor with up to eight cores in an LGA1200 socket.

Memory Support

The X12STL-IF motherboard supports up to 64GB of DDR4 ECC UDIMM in two slots. Speed support is up to 2666MHz when a Pentium processor is installed. Speed support is up to 2933 MT/s for 2R2R configurations. For optimal performance, use memory modules of the same type and speed.

Back Panel I/O Connectors

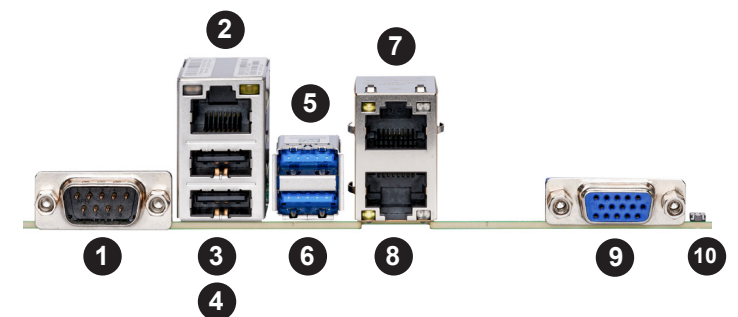

#	Description	#	Description
1.	COM1	6.	USB4
2.	BMC LAN Port	7.	LAN2
3.	USB1	8.	LAN1
4.	USB0	9.	VGA
5.	USB5	10.	UID Switch

CPU Installation

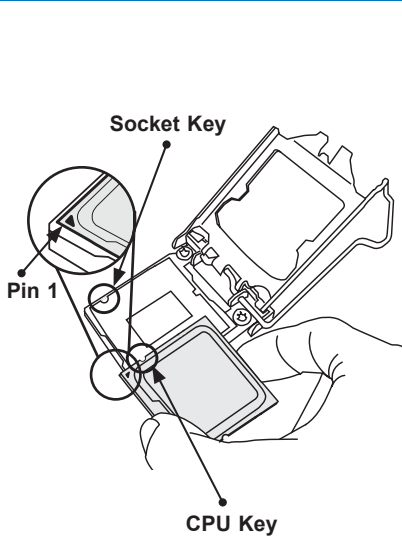

Heatsink Installation

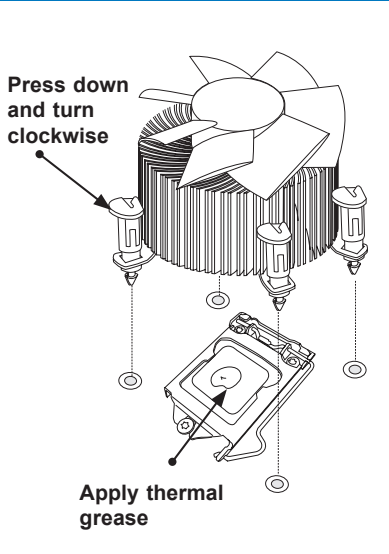

Front Control Panel

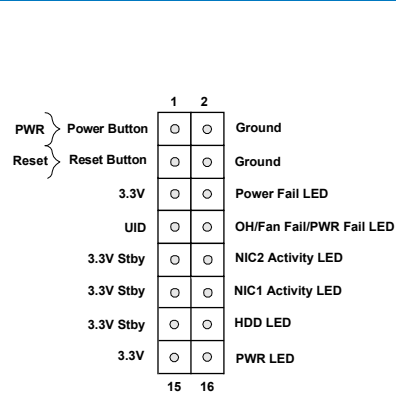

Note: Graphics shown in this quick reference guide are for illustration only. Your components may or may not look exactly the same as drawings shown in this guide.

Note: Refer to Chapter 2 of the User Manual for detailed information on jumpers, connectors, and LED indicators.

Note: Refer to Chapter 2 of the User Manual for detailed information on memory support and CPU/motherboard installation instructions.