

CONTACT INFORMATION

- Website: www.supermicro.com
- General Information: marketing@supermicro.com
- Technical Support: support@supermicro.com
- Phone: +1 (408) 503-8000, Fax: +1 (408) 503-8008

FOR YOUR SYSTEM TO WORK PROPERLY, PLEASE DOWNLOAD APPROPRIATE

DRIVERS/IMAGES/USER'S MANUAL FROM THE LINKS BELOW:

- Manuals: <http://www.supermicro.com/support/manuals>
- Drivers & Utilities: <https://www.supermicro.com/wdl/driver/>
- Safety: http://www.supermicro.com/about/policies/safety_information.cfm

PACKAGE CONTENTS

- One Supermicro Motherboard
- One Quick Reference Guide
- Two SATA Cables
- Two CPU Carriers



WARNING: This product can expose you to chemicals including lead, known to the State of California to cause cancer and birth defects or other reproductive harm. For more information, go to www.P65Warnings.ca.gov.

Motherboard Layout and Features

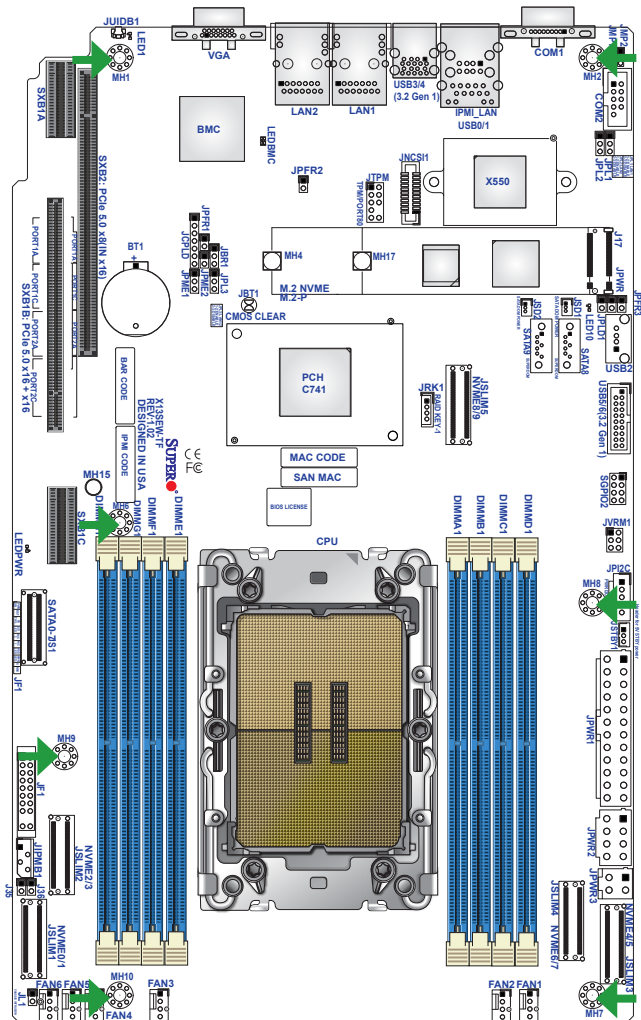

➔ = mounting hole

CPU and PHM Installation

- 1 Assemble the processor carrier assembly by inserting the CPU into the processor carrier.

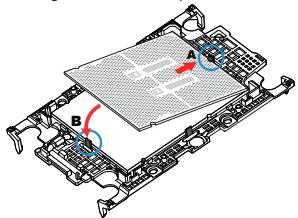

- 2 To form the processor heatsink module (PHM), mount the processor carrier assembly onto the heatsink and snap into place.

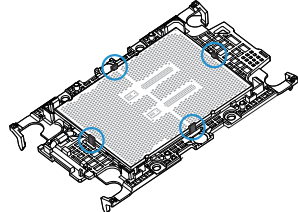

- 3 After assembling the PHM, mount it onto the CPU socket. With a T30 bit torque driver set to a force of 8.0 in-lbf (0.904 N-m), gradually tighten the four screws.

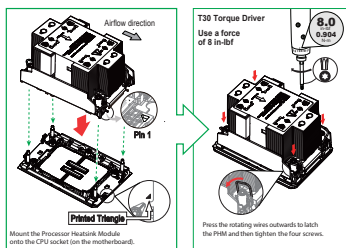

The CPU carriers XCC (SKT-1333L-0000-FXC) and MCC (SKT-1424L-001B-FXC) are included in the shipping package.

Front Control Panel

	1	2	
PWR	Power Button	Ground	
Reset	Reset Button	Ground	
	3.3 V	Power Fail LED	
	UID LED	3.3 V	
	3.3 V Stby	NIC2 Activity LED	
	3.3 V Stby	NIC1 Activity LED	
	3.3 V Stby	HDD LED	
	3.3 V Stby	PWR LED	
	X	X	
	NMI	Ground	
	19	20	

Jumpers and Connectors

Jumpers		
Jumper	Description	Default Setting
JBR1	BIOS Recovery	Pins 1-2 (Normal)
JBT1	CMOS Clear	Open (Normal)
JPL1	I210 LAN1 Enable/Disable	Pins 1-2 (Enabled) Pins 2-3 (Disabled)
JPL2	I210 LAN2 Enable/Disable	Pins 1-2 (Enabled) Pins 2-3 (Disabled)
JPL3	X550 LAN1 and LAN2 Enable/Disable	Pins 1-2 (Enabled) Pins 2-3 (Disabled)
JPME1	ME Manufacturing Mode	Pins 1-2 (Normal)
JVRM1	VRM SMB Clock (to BMC) VRM SMB DATA (to BMC)	Pins 1-2 (Normal) Pins 3-4 (Normal)

Connectors	
Connector	Description
BT1	Onboard Battery
COM1, COM2	COM Port/COM Header
FAN1–FAN6	CPU/System Fan Headers (FAN1: CPU Fan)
IPMI LAN	Dedicated IPMI LAN Port
J17	M.2 Connector (supports M-Key 2280 and 22110)
JCPLD	CPLD Programming Header
JF1	Front Control Panel Header
JIPMB1	System Management Bus Header (for IPMI only)
JL1	Chassis Intrusion Header
JNCSI1	NC-SI Port Selection
JPI2C	Power System Management Bus I ² C Header
JPWR1	24-pin ATX Power Connector (Required)

JPWR2, JPWR3	12 V 8-pin and 4-pin CPU Power Connectors (To provide alternative power for special enclosure when the 24-pin ATX power is not in use.)
JRK1	Intel® RAID Key Header
JSD1, JSD2	SATA DOM Power Connectors
JSLIM1–JSLIM5	MCIO Connectors (PCIe 5.0 x8)
JSTBY1	Standby Power Connector
JTPM	Trusted Platform Module (TPM)/Port 80 Connector
JUIDB1	Unit Identifier Switch
LAN1, LAN2	LAN (RJ45) Ports
SATA0–7 (Slimline SAS)	Intel PCH SATA 3.0 Ports (with RAID 0, 1, 5, and 10)
SATA8, SATA9	SATA 3.0 Ports with SuperDOM Power
SXB1A, SXB1B, SXB1C	PCIe 5.0 x16 + x16 Supermicro Proprietary WIO Left Add-on Card Slots

Note: Refer to Chapter 1 of the User Manual for detailed information on jumpers, connectors, and LED indicators.

Connectors and LED Indicators

Connectors		
Connector	Description	
SXB2	PCIe 5.0 x8 (In x16) Supermicro Proprietary WIO Right Add-on Card Slot	
SGPIO2	Serial Link General Purpose I/O Header	
USB0/1	Back Panel USB 2.0 Ports	
USB2	Front Access USB 2.0 Type A Header	
USB3/4	Back Panel USB 3.2 Gen 1 Ports	
USB5/6	Front Access USB 3.2 Gen 1 Headers	
VGA	VGA Port	

LED Indicators		
LED	Description	Status
LED1	Unit Identifier LED	Solid Blue: Unit Identified
LED10	M.2 LED	Blinking: Device Working
LEDBMC	BMC Heartbeat	Blinking Green: Device Working
LEDPWR	Onboard Power LED	Solid Green: Power On

CPU and Memory Support

The X13SEW-TF/-F motherboard supports the 4th and 5th Generation Intel® Xeon® Scalable Processors with up to 60 (4th Generation) or 64 (5th Generation) cores in a Socket E socket.

The motherboard supports up to 2 TB of ECC RDIMM/RDIMM 3DS DDR5 memory in eight memory slots. The 4th Generation Intel® Xeon® Scalable Processor memory has speeds of up to 4800 MT/s, while the 5th Generation Intel® Xeon® Scalable Processor memory has speeds of up to 5600 MT/s.

1 CPU, 8 DIMM Slots	
Number of DIMMs	Memory Population Sequence
1	DIMMA1 DIMME1 DIMMA1 / DIMMG1 DIMMC1 / DIMME1
2	DIMMA1 / DIMMG1 / DIMMC1 / DIMME1
4	DIMMA1 / DIMMG1 / DIMMC1 / DIMME1 DIMMA1 / DIMMG1 / DIMMC1 / DIMME1 / DIMMD1 / DIMMF1 DIMMC1 / DIMME1 / DIMMB1 / DIMMH1 / DIMMD1 / DIMMF1 DIMMA1 / DIMMG1 / DIMMB1 / DIMMH1 / DIMMD1 / DIMMF1
8	DIMMA1 / DIMMG1 / DIMMB1 / DIMMH1 / DIMMD1 / DIMMF1 / DIMMC1 / DIMME1

Back Panel I/O Connectors

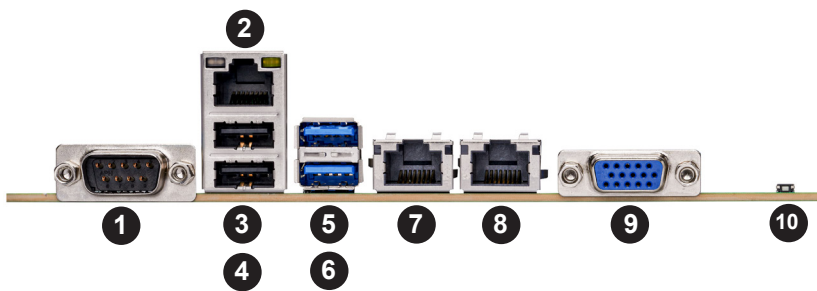

#	Description	#	Description	#	Description
1.	COM1	5.	USB3 (3.2 Gen 1)	9.	VGA
2.	IPMI_LAN	6.	USB4 (3.2 Gen 1)	10.	UID Switch
3.	USB0 (2.0)	7.	LAN1		
4.	USB1 (2.0)	8.	LAN2		

Note: Refer to Chapter 2 of the User Manual for detailed information on memory support and CPU/motherboard installation instructions.

Note: Graphics shown in this quick reference guide are for illustration only. Your components may or may not look exactly the same as drawings shown in this guide.