

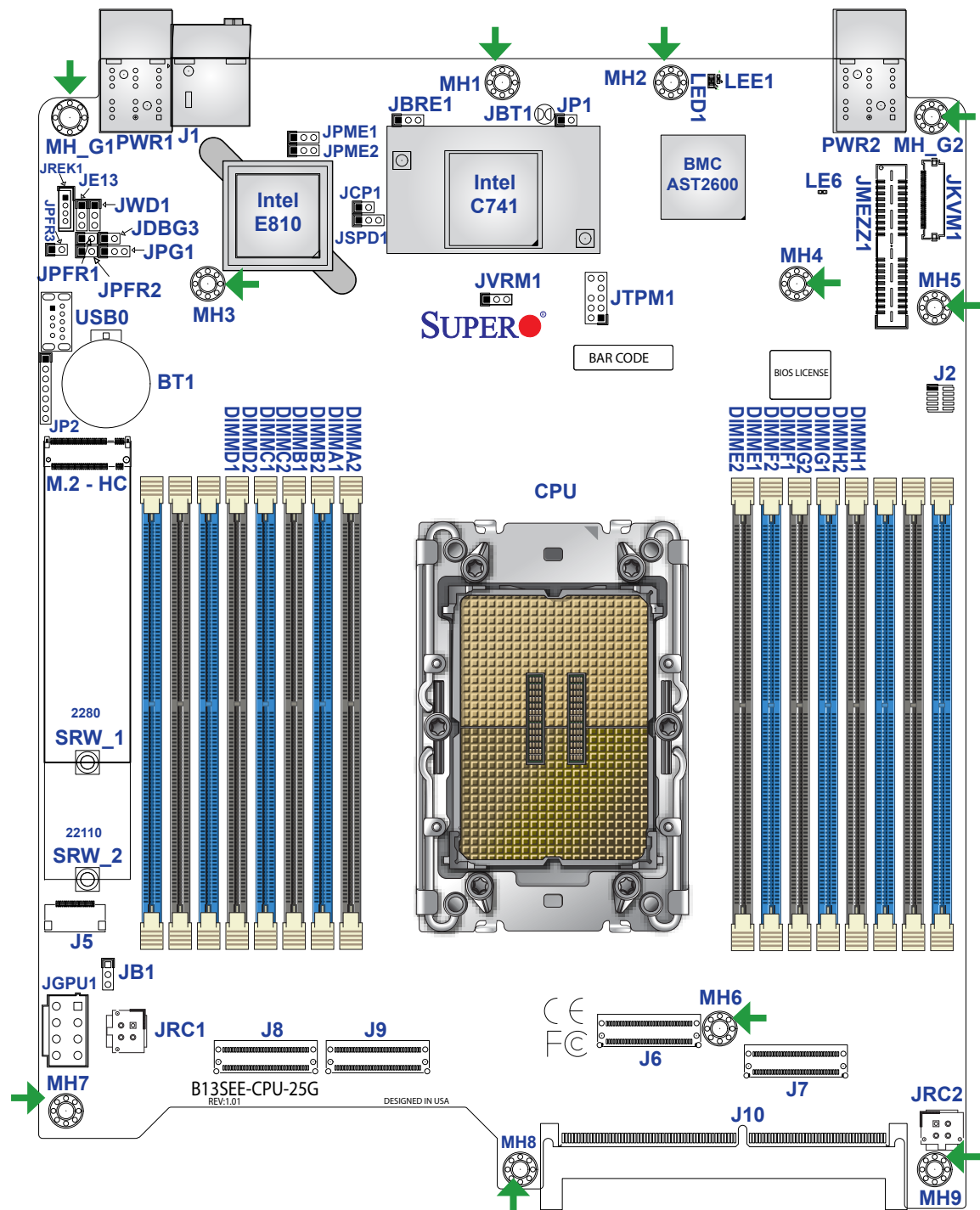

**Motherboard Layout and Features**



➔ = mounting hole

**Note:** Graphics shown in this quick reference guide are for illustration only. Your components may or may not look exactly the same as drawings shown in this guide.

**Jumpers, Connectors, and LED indicators**

Jumpers		
Jumper	Description	Default Setting
JBRE1	BIOS Recovery	Pins 1-2 (Normal)
JPG1	VGA Enable/Disable	Pins 1-2 (Enable)
JPME1	ME Recovery Mode	Pins 1-2 (Normal)
JPME2	Manufacturing Mode	Pins 1-2 (Normal)
JWD1	Watchdog Timer	Pins 1-2 (Reset)

Connectors		
Connector	Description	
BT1	Onboard CMOS Battery	
J1	Chassis Backplane Connector	
J5	Front Panel Connector	
J6, J7, J8, J9	PCIe 5.0 x8 MCIO Connectors	
J10	PCIe 4.0 x16 SIOM Connector for one SAS card or two PCIe 4.0 NVMe	
JKVM1	VGA/USB Module Connector	
JGPU1	12 V GPU Power Connector (ATX 8-pin)	
JRC1	Proprietary Riser Power Connector	
JRC2	Proprietary Riser Power Connector	
JREK1	Intel RAID Key Header	
JMEZZ1	PCIe 4.0 x16 Mezzanine Card Connector for AOM	
JTPM1	Trusted Platform Module (TPM)/Port 80 Connector	
M.2-HC	M.2 M-Key PCIe 3.0 or SATA 3.0 Connector (2280/22110)	
PWR1	Power Receptacle to Chassis Backplane	
PWR2	Power Receptacle to Chassis Backplane	
USB0	Internal USB 2.0/3.0 Type-A Connector	
MH_G1, MH_G2	Mounting Holes	
MH1-MH9	Mounting Holes	
SRW_1 - SRW_2	M.2 Mounting Holes	

LED Indicators		
LED	Description	Status
LED1	BMC Heartbeat LED	Blinking Green: BMC Normal

**Note:** Refer to Chapter 1 of the User Manual for detailed information on jumpers, connectors, and LED indicators.

**Memory and CPU Support**

**Memory Support**  
 The B13SEE-CPU-25G motherboard supports up to 4 TB of DDR5 ECC RDIMM/3DSRDIMM memory with speeds of up to 5600 MT/s in 8 DIMM slots or 4400 MT/s in 16 DIMM slots.

Number of DIMMs	Memory Population Sequence
1	DIMMA1 DIMME1 DIMMB1 DIMMF1
2	DIMMA1 / DIMMG1 DIMMC1 / DIMME1
4	DIMMA1 / DIMMG1 / DIMMC1 / DIMME1
6	DIMMA1 / DIMMG1 / DIMMC1 / DIMME1 / DIMMD1 / DIMMF1 DIMMC1 / DIMME1 / DIMMB1 / DIMMH1 / DIMMD1 / DIMMF1 DIMMA1 / DIMMG1 / DIMMB1 / DIMMH1 / DIMMD1 / DIMMF1
8	DIMMA1 / DIMMG1 / DIMMB1 / DIMMH1 / DIMMD1 / DIMMF1 / DIMMC1 / DIMME1
12	DIMMA1 / DIMMA2 / DIMMB1 / DIMMC1 / DIMMC2 / DIMMD1 / DIMME1 / DIMME2 / DIMMF1 / DIMMG1 / DIMMG2 / DIMMH1 DIMMA1 / DIMMB1 / DIMMB2 / DIMMC1 / DIMMD1 / DIMMD2 / DIMME1 / DIMMF1 / DIMMF2 / DIMMG1 / DIMMH1 / DIMMH2
16	DIMMA1 / DIMMA2 / DIMMB1 / DIMMB2 / DIMMC1 / DIMMC2 / DIMMD1 / DIMMD2 / DIMME1 / DIMME2 / DIMMF1 / DIMMF2 / DIMMH1 / DIMMH2 / DIMMG1 / DIMMG2

**CPU Installation**

The B13SEE-CPU-25G motherboard supports a 4th and 5th Generation Intel<sup>®</sup> Xeon<sup>®</sup> Scalable Processor with up to 64 cores and 350 W TDP in an LGA4677 socket.

- Assemble the processor carrier assembly by inserting the CPU into the processor carrier.
- To form the processor heatsink module (PHM), mount the processor carrier assembly onto the heatsink and snap into place.

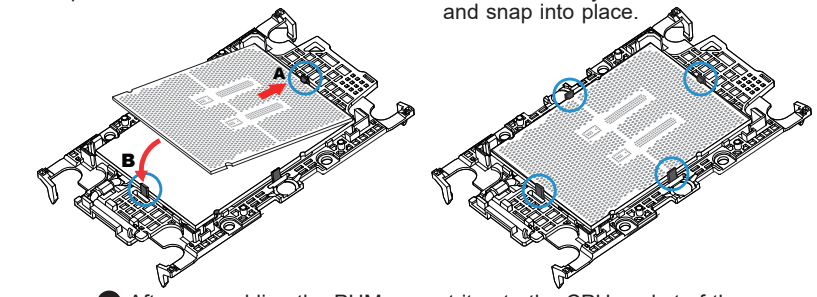

- After assembling the PHM, mount it onto the CPU socket of the motherboard. With a T30 bit torque driver set to a force of 8.0 in-lbf (0.904 N-m), gradually tighten the four screws.

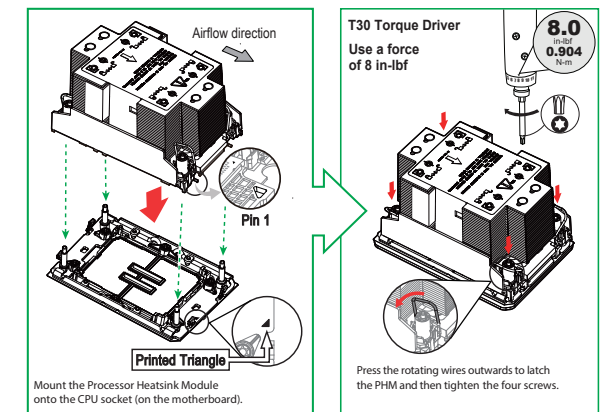

**Note:** Refer to Chapter 2 of the User Manual for detailed information on memory support and CPU/motherboard installation instructions.