

CONTACT INFORMATION

- Website: www.supermicro.com
- General Information: marketing@supermicro.com
- Technical Support: support@supermicro.com
- Phone: +1 (408) 503-8000, Fax: +1 (408) 503-8008

FOR YOUR SYSTEM TO WORK PROPERLY, PLEASE DOWNLOAD APPROPRIATE

- DRIVERS/IMAGES/USER'S MANUAL FROM THE LINKS BELOW:**
- Manuals: <http://www.supermicro.com/support/manuals>
 - Drivers & Utilities: <https://www.supermicro.com/wdl/driver/>
 - Safety: http://www.supermicro.com/about/policies/safety_information.cfm

PACKAGE CONTENTS

- One Supermicro Motherboard
- One Quick Reference Guide
- Two SATA Cables
- One I/O Shield
- One 4-pin ATX Power Signal Cable



Motherboard Layout and Features

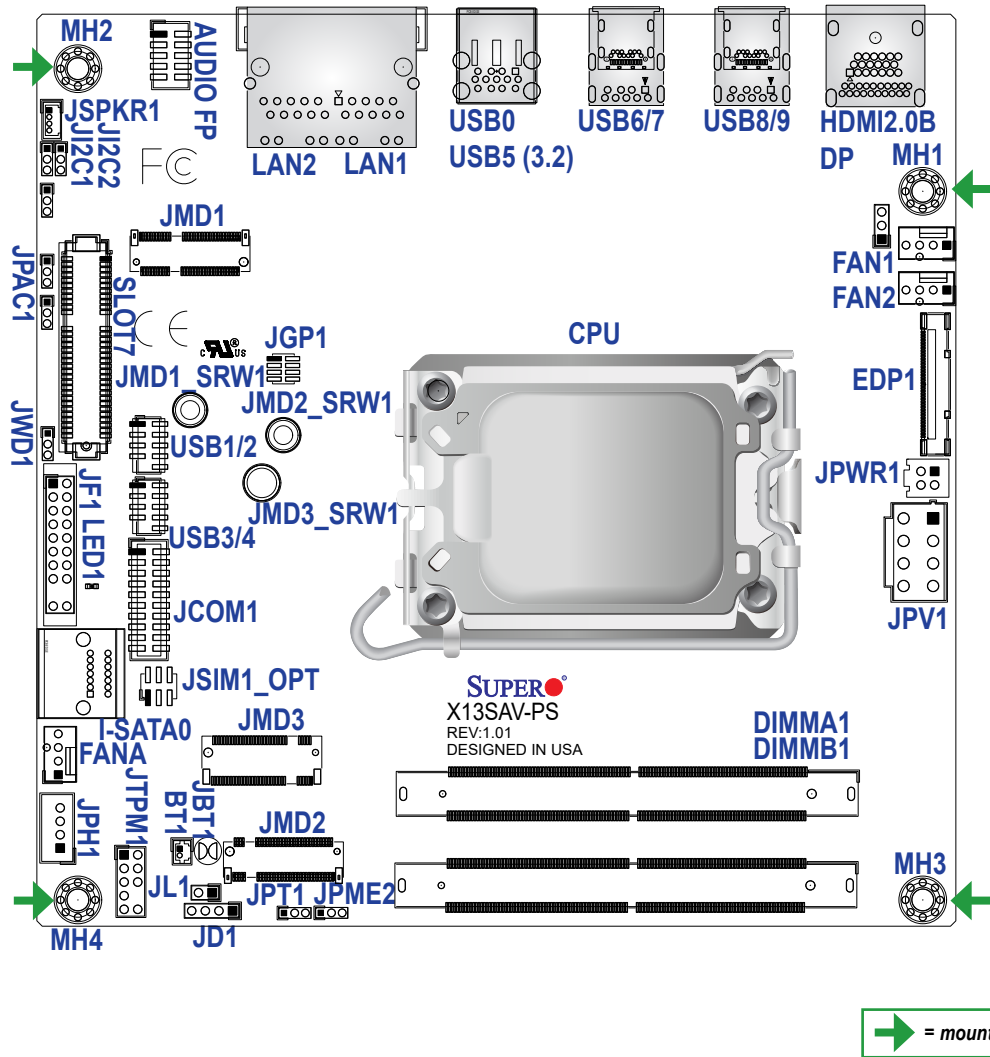

Jumpers, Connectors, and LED Indicators

| Jumpers | | |
|--------------------------------------|----------------------------------|--|
| Jumper | Description | Default Setting |
| JBT1 | CMOS Clear | Open (Normal) |
| J ² C1, J ² C2 | SMB to PCIe Slots Enable/Disable | Pins 2-3 (Disabled) |
| JPAC1 | Audio Enable | Pins 1-2 (Enabled) |
| JPME2 | ME Manufacturing Mode | Pins 1-2 (Normal) |
| JPT1 | Onboard TPM Enable/Disable | Pins 2-3 (Disabled) |
| | SIM DETECT | Pins 2-4 (Low active) Pins 2-4 Open (High active) |
| JSIM1_OPT | SIERRA LTE IF-SEL | Pins 1-3 (USB) Pins 1-3 Open (PCIe) |
| | B-key LED_N | Pins 5-6 (Enabled LED Function) Pins 5-6 Open (Disabled LED Function) |
| JWD1 | Watch Dog Timer | Pins 1-2 (Reset) |

| Connectors | |
|-------------------|---|
| Connector | Description |
| AUDIO FP | Front Front Audio Ports (Line Out/Mic In) |
| BT1 | CMOS Battery Header |
| EDP1 | Embedded DisplayPort (eDP) |
| FAN1 – FAN2, FANA | Fan Headers |
| HDMI2.0/DP | High Definition Multimedia Interface 2.0 and DisplayPort |
| I-SATA0 | SATA 3.0 Port |
| JCOM1 | COM Header (supports RS-232/422/485) |
| JD1 | Buzzer (Pins 1-4: Buzzer) |
| JF1 | Front Control Panel Header |
| JGP1 | General Purpose I/O Header |
| JL1 | Chassis Intrusion Header |
| JMD1 | M.2 E-Key PCIe 3.0 x1/USB 2.0 (2230 form factor) |
| JMD2 | M.2 M-Key PCIe 4.0 x4 (2280 form factor) |
| JMD3 | M.2 B-Key PCIe 3.0 x2/USB 3.0/USB 2.0 (3052 form factor) |
| JMD1/2/3_SRW1 | M.2 Holding Screws |
| JPH1 | 4-pin HDD Power Connector |
| JPV1 | 8-pin 12V DC Power Connector for CPU (required) or alternative single power input for when the 24-pin ATX power is not in use |
| JPWR1 | Header for ATX Power Signal 5VSTBY/Power ON/Power GOOD/Ground |
| JSPKR1 | Speaker Header (supports up to 2W) |
| JTPM1 | Trusted Platform Module/Port 80 Connector |
| LAN1, LAN2 | 2.5G LAN Ports |
| MH1 – MH4 | Mounting Holes |
| SLO7 | PCIe 4.0 x4 Slot |
| USB0 | Back Panel USB 2.0 Port |
| USB1/2, 3/4 | Front Accessible USB 2.0 Headers |
| USB5/6/7/8/9 | Back Panel USB 3.2 Gen2 x1 Ports (USB6/8: DisplayPort/USB 3.2) |

| LED Indicators | | |
|----------------|-------------|--|
| LED | Description | Status |
| LED1 | Power LED | Solid Green: Power On Blinking Green: S3 Status |

CPU Support

X13SAV-PS supports an Intel® 12th Generation Core i3/i5/i7 series and Celeron processors up to 65W in an LGA1700 socket.

There is a limitation of a maximum of five CPU replacements without an SPI re-flash/replacement needed.

Memory Support

The X13SAV-PS supports up to 64GB of DDR5 Non-ECC SODIMM with speeds of up to 4800 MT/s in two memory slots.

1. Insert SODIMM modules into slot DIMMA1 and then DIMMB1. Align the key on the bottom of the DIMM module against the receptive point on the memory slot. Take note of the notches on the side of the DIMM module and of the locking clips to avoid causing damage.

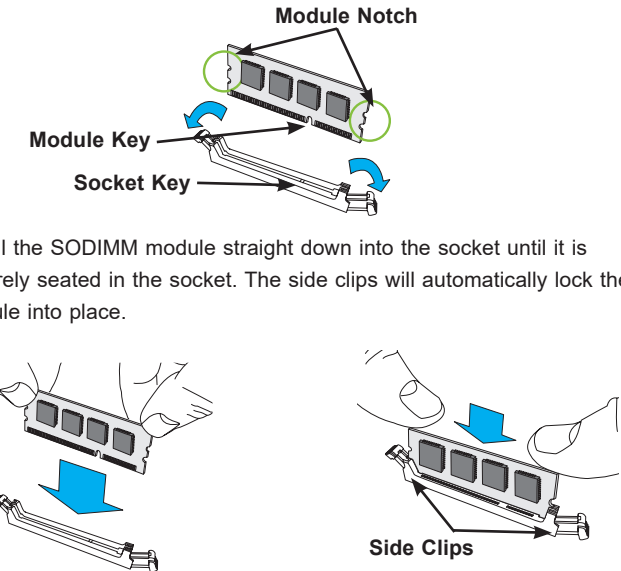

Back Panel I/O Connectors

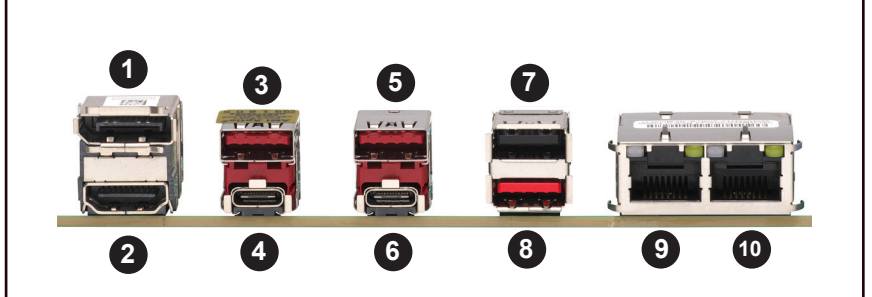

| # | Description | # | Description | # | Description |
|----|---------------|----|---------------|-----|-------------|
| 1. | DP | 5. | USB7 (3.2) | 9. | 2.5G LAN1 |
| 2. | HDMI 2.0 | 6. | USB6 (Type C) | 10. | 2.5G LAN2 |
| 3. | USB9 (3.2) | 7. | USB6 (2.0) | | |
| 4. | USB8 (Type C) | 8. | USB5 (3.2) | | |

CPU Installation

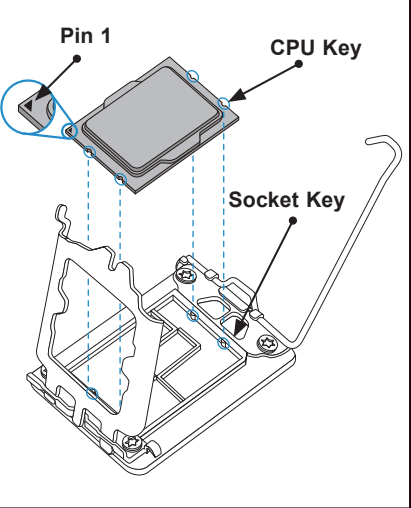

Heatsink Installation

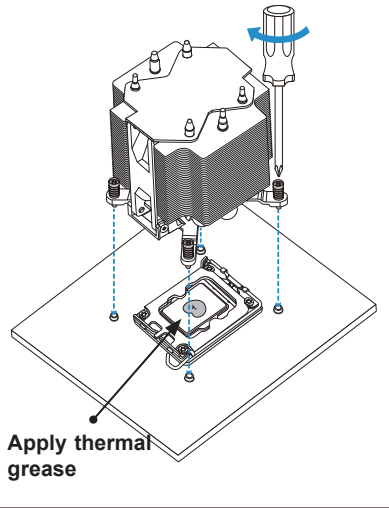

Front Control Panel

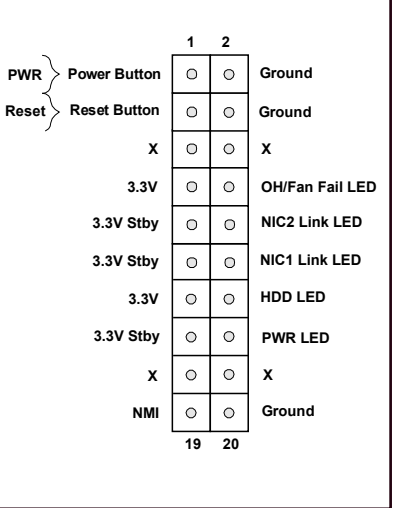

Note: Graphics shown in this quick reference guide are for illustration only. Your components may or may not look exactly the same as drawings shown in this guide.

Note: Refer to Chapter 2 of the User Manual for detailed information on jumpers, connectors, and LED indicators.

Note: Refer to Chapter 2 of the User Manual for detailed information on memory support and CPU/motherboard installation instructions.