

# SUPERMICR<sup>®</sup> SuperServer 5017C-MTF/MTRF Quick Reference Guide

## Board Layout

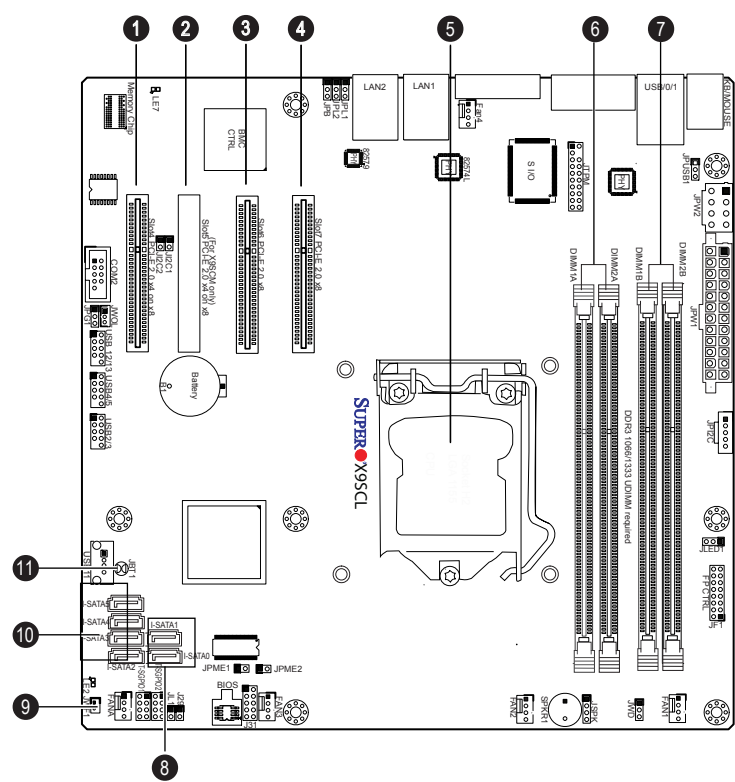

No.	Description
1	Slot4 PCI-E 2.0 x4 on x8 slot
2	N/A
3	Slot6 PCI-E 2.0 x8
4	Slot7 PCI-E 2.0 x8
5	CPU1
6	DIMM1A / DIMM2A (Blue Slot)
7	DIMM1B / DIMM2B (Blue Slot)
8	SATA 2.0 (0/1 Ports)
9	JWF1 = SATA DOM Power Connector
10	SATA 2.0 (2/3/4/5 Ports)
11	JBT1 = CMOS Clear

## MEMORY

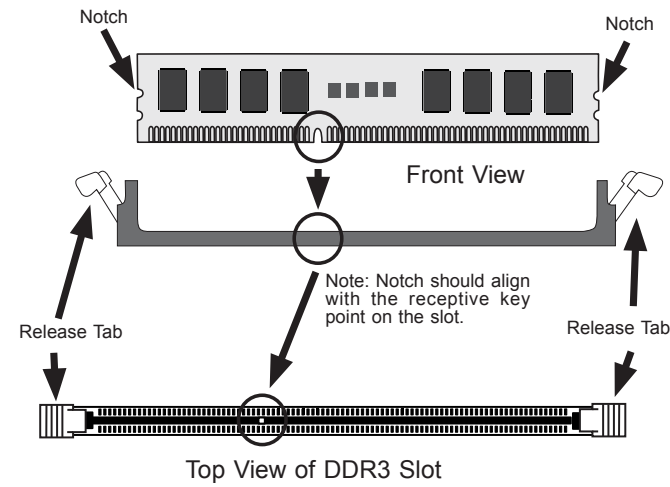

DDR3 Unbuffered (UDIMM) Memory				
DIMM Slots per Channel	DIMMs Populated per Channel	DIMM Type	POR Speeds	Ranks per DIMM (any combination)
2	1	Unbuffered DDR3	1066, 1333	Single Rank, Dual Rank
2	2	Unbuffered DDR3	1066, 1333	Single Rank, Dual Rank

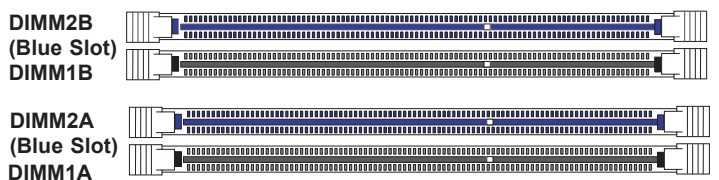

## Beep Codes

BIOS Error Beep Codes		
Beep Code/LED	Error Message	Description
1 beep	Refresh	Circuits have been reset. (Ready to power up)
5 short beeps + 1 long beep	Memory error	No memory detected in the system
8 beeps	Display memory read/write error	Video adapter missing or with faulty memory
OH LED On	System OH	System Overheat

## Front View & Interface

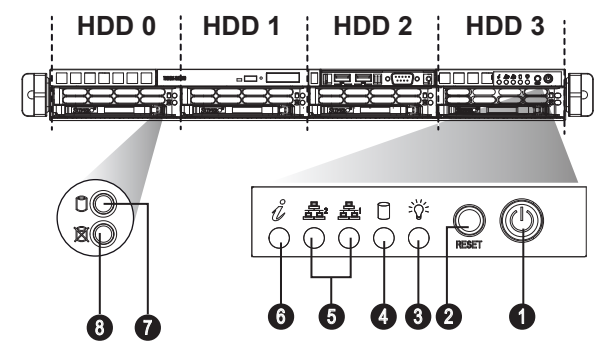

No.	Description
1	Power Button
2	Reset Button
3	Power LED
4	Device Activity LED
5	LAN1 LED & LAN2 LED
6	Information LED
7	Hard Drive Signal
8	Hard Drive Fail

## Rear View

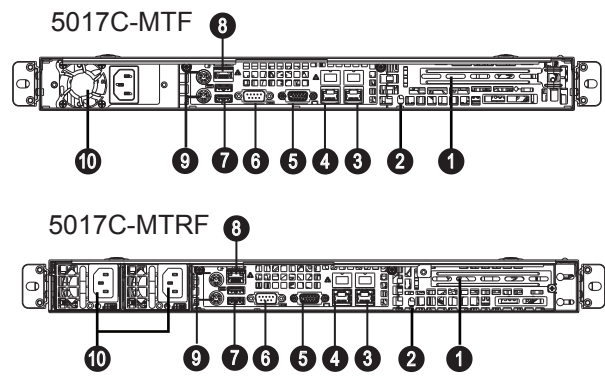

No.	Description
1	PCI-E Expansion Slot (w/riser card)
2	UID
3	GbE LAN2 Port
4	GbE LAN1 Port
5	VGA Port
6	COM1 Port
7	USB 0/1 Ports
8	Dedicated LAN for IPMI
9	PS2 keyboard (purple) & Mouse (green) Ports
10	Single/Redundant Power Supply Module

## CPU Installation

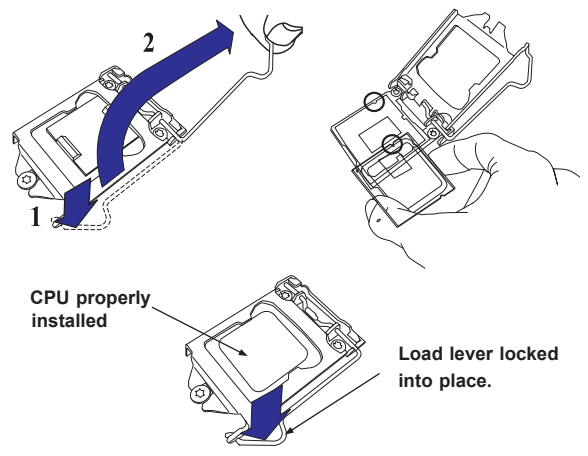

## Heatsink Installation

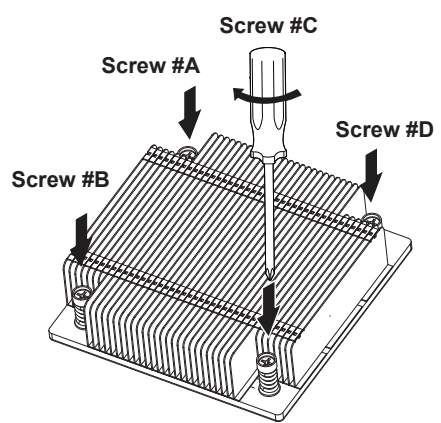

## Caution

**SAFETY INFORMATION**  
IMPORTANT: See installation instructions and safety warning before connecting system to power supply.  
[http://www.supermicro.com/about/policies/safety\\_information.cfm](http://www.supermicro.com/about/policies/safety_information.cfm)

**WARNING:**  
To reduce risk of electric shock/damage to equipment, disconnect power from server by disconnecting all power cords from electrical outlets.  
If any CPU socket empty, install protective plastic CPU cap

**CAUTION:**  
Always be sure all power supplies for this system have the same power output. If mixed power supplies are installed, the system will not operate.

For more information go to :  
<http://www.supermicro.com/support>

## SATA Drive Installation

### Mounting a Drive in a Drive Carrier

The SATA drives are mounted in drive carriers to simplify their installation and removal from the chassis. These carriers also help promote proper airflow for the system. For this reason, even empty carriers without drives installed must remain in the chassis.

1. Install a new drive into the carrier with the printed circuit board side facing down so that the mounting holes align with those in the carrier.
2. Secure the drive to the carrier with six screws, as shown.

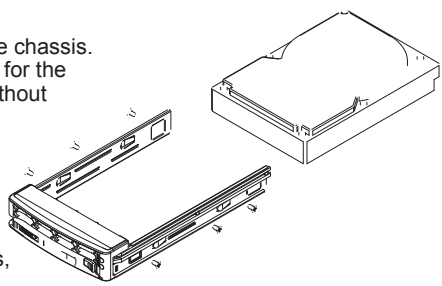

### Installing/Removing SATA Drives

1. To remove a carrier, push the release button located beside the drive LEDs.
2. Swing the colored handle fully and use it to pull the unit straight out.

