

SUPERMICR[®] SuperServer 5017C-URF Quick Reference Guide

Board Layout

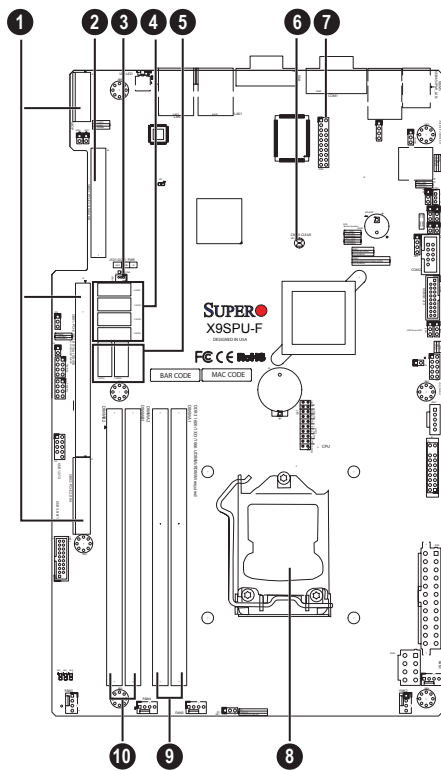

No.	Description
1	SBX1, SBX3, UIO-RISER slot
2	SBX2: Slot for Supermicro riser card P/N RSC-R1UW-E8R
3	JSD1: SATA DOM Power Connector
4	I-SATA2 ~ I-SATA5: SATA 2.0 Connectors via PCH (3Gb/s)
5	I-SATA0 ~ I-SATA1: SATA 3.0 Connectors via PCH (6Gb/s)
6	JBT1 = CMOS Clear
7	JTPM: Trusted Platform Module (TPM) Header
8	CPU socket
9	DIMMA1 / DIMMA2 (Blue Slot)
10	DIMMB1 / DIMMB2 (Blue Slot)

MEMORY

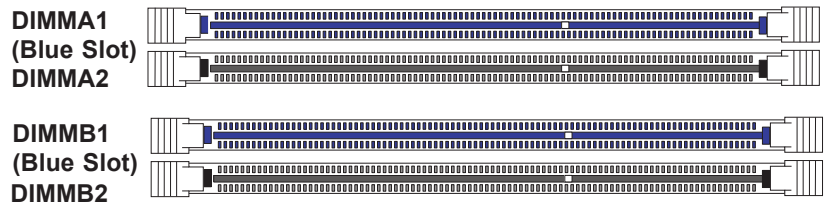
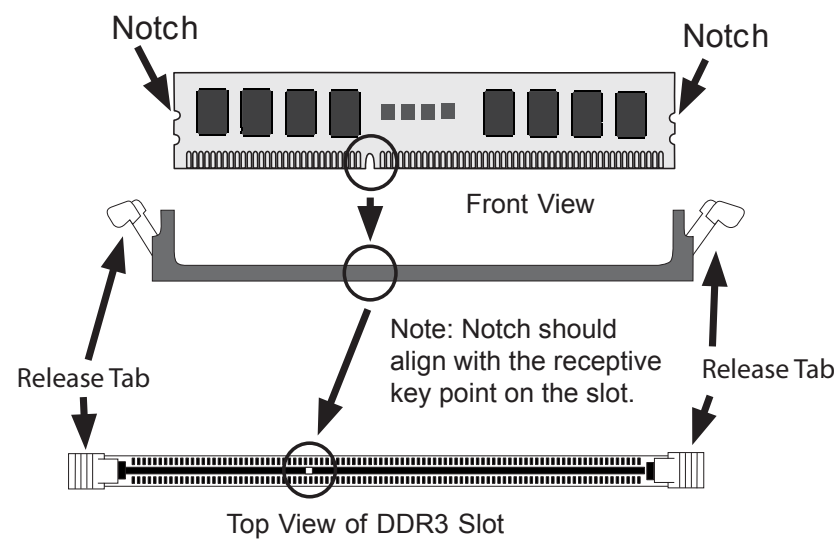

Recommended Population (Balanced)				
DIMMA1	DIMMB1	DIMMA2	DIMMB2	Total System Memory
2GB	2GB			4GB
2GB	2GB	2GB	2GB	8GB
4GB	4GB			8GB
4GB	4GB	4GB	4GB	16GB
8GB	8GB			16GB
8GB	8GB	8GB	8GB	32GB

Front View & Interface

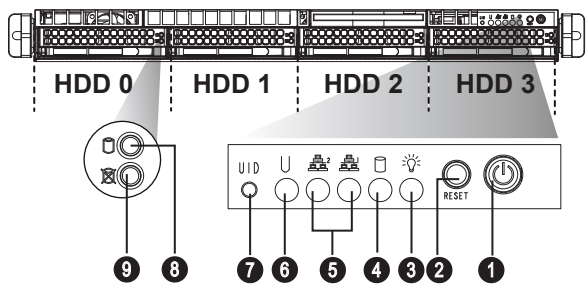

No.	Description
1	Power Button
2	Reset Button
3	Power LED
4	Device Activity LED
5	LAN1 LED & LAN2 LED
6	Information LED
7	UID Button
8	Hard Drive Signal
9	Hard Drive Fail

Rear View

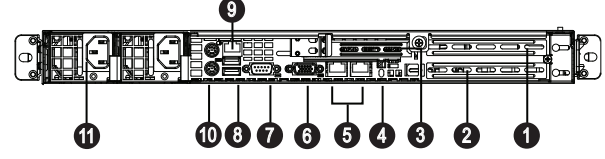

No.	Description
1	PCI-E 3.0 x16 Expansion Slot (FH)
2	UIO Expansion Slot (PCI-E x4 signal)
3	PCI-E 3.0 x8 (x4 signal, LP) Expansion Slot
4	UID Button (Unit Identifier Button)
5	LAN1/LAN2 Ports
6	VGA Port
7	COM Port
8	USB3/USB4 Ports
9	Dedicated LAN for IPMI
10	PS/2 Keyboard & Mouse Ports
11	Redundant Power Supply Module

CPU Installation

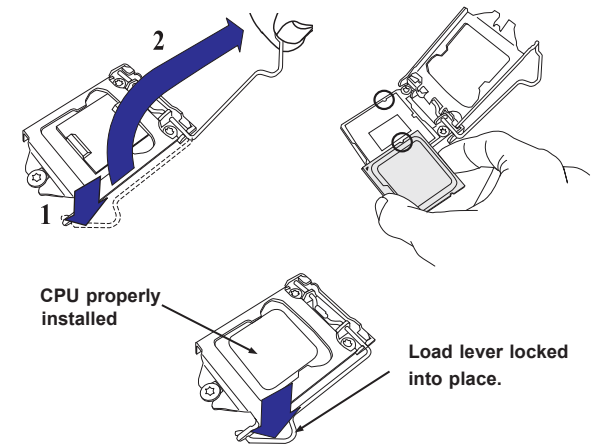

Heatsink Installation

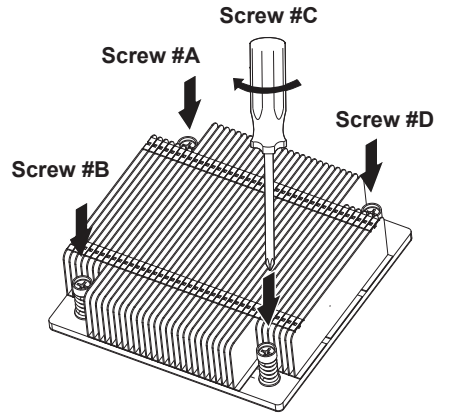

1. Place heatsink on top of installed CPU
2. Line up the four screws to socket
3. Push down heatsink and screw down as shown (cross pattern, in order: A, C, B, D)
4. NOTE: Only use 6-8 lb/f of torque; otherwise, hand-tighten each screw, to avoid damaging the system

Caution

SAFETY INFORMATION
IMPORTANT: See installation instructions and safety warning before connecting system to power supply.
http://www.supermicro.com/about/policies/safety_information.cfm

WARNING:
To reduce risk of electric shock/damage to equipment, disconnect power from server by disconnecting all power cords from electrical outlets.
If any CPU socket empty, install protective plastic CPU cap

CAUTION:
Always be sure all power supplies for this system have the same power output. If mixed power supplies are installed, the system will not operate.

For more information go to :
<http://www.supermicro.com/support>

SATA Drive Installation

Mounting a Drive in a Drive Carrier

The SATA drives are mounted in drive carriers to simplify their installation and removal from the chassis. These carriers also help promote proper airflow for the system. For this reason, even empty carriers without drives installed must remain in the chassis.

1. Install a new drive into the carrier with the printed circuit board side facing down so that the mounting holes align with those in the carrier.
2. Secure the drive to the carrier with six screws, as shown.

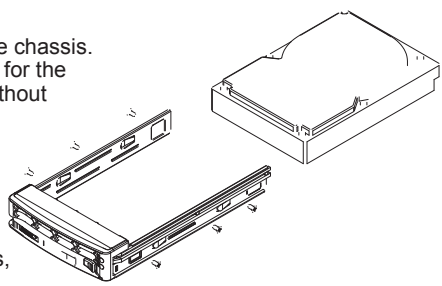

Installing/Removing SATA Drives

1. To remove a carrier, push the release button located beside the drive LEDs.
2. Swing the colored handle fully and use it to pull the unit straight out.

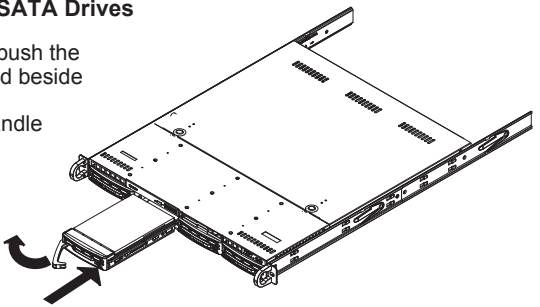

Beep Codes

BIOS Error Beep Codes		
Beep Code/LED	Error Message	Description
1 beep	Refresh	Circuits have been reset. (Ready to power up)
5 short beeps + 1 long beep	Memory error	No memory detected in the system
8 beeps	Display memory read/write error	Video adapter missing or with faulty memory
OH LED On	System OH	System Overheat

