

SUPERMICR[®] SuperServer 5017A-EP Quick Reference Guide

Board Layout

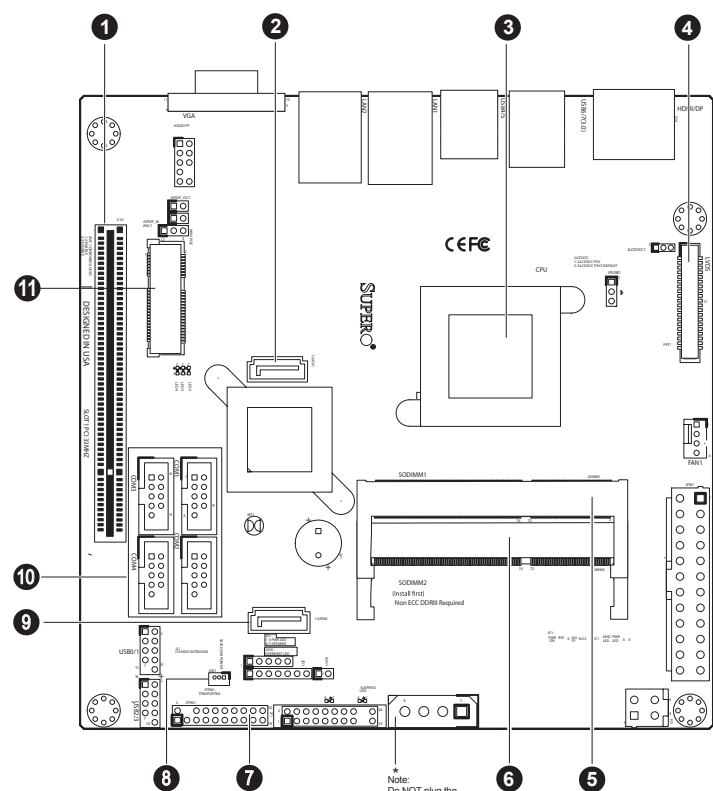

No.	Description
1	PCI 33MHz 5V Slot
2	I-SATA1: SATA 2.0 port
3	Embedded CPU
4	LVDS: LVDS Port for VGA (Optional HDMI/Dual Display)
5	SO-DIMM1 Memory Slot
6	SO-DIMM2 Memory Slot
7	JTPM = TPM (Trusted Platform Management) Header
8	JSD1 = SATA Disk on Module (DOM) Power
9	I-SATA0: SATA 2.0 port
10	COM1, 2, 3, 4: Internal Headers for COM1~4
11	Mini PCI-E socket

Beep Codes

When a recoverable type of error occurs during POST, BIOS will display a POST code that describes the problem. BIOS may also issue one of the following beep codes:

- 1 Long and two short beeps - video configuration error
- 1 repetitive long beep - no memory detected
- 1 continuous beep with the front panel Overheat LED on - system overheat
- 8 short beeps - display memory read/write error

MEMORY

1. Position the SO-DIMM module's bottom key so that it aligns with the receptive point on the slot.
2. Insert the SO-DIMM module vertically at about a 45 degree angle.
3. Press down until the module locks into place. The side clips will automatically secure the SO DIMM module, locking it into place.
4. To Remove: Use your thumbs to gently push the side clips near both ends away from the module. This should release it from the slot. Pull the SO DIMM module upwards.

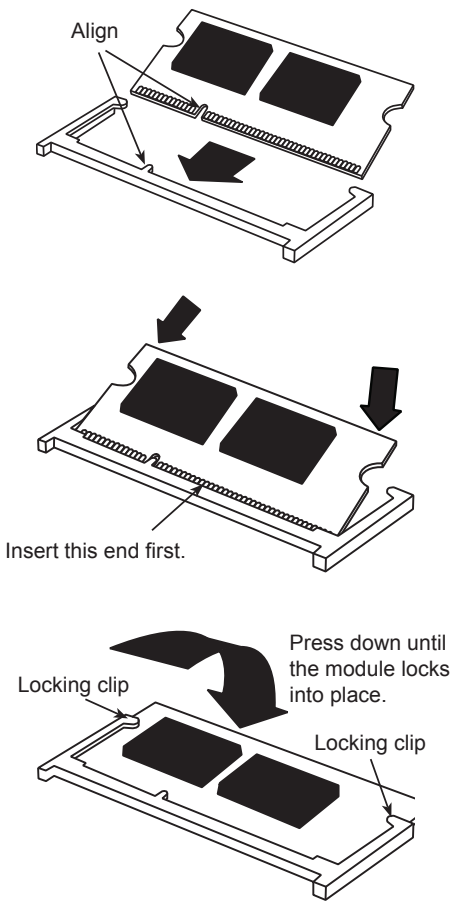

Front View & Interface

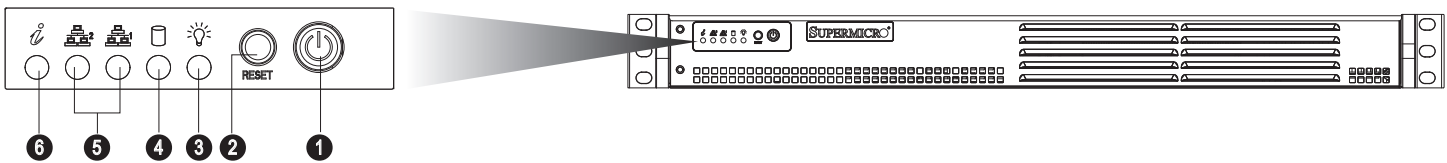

No.	Description
1	Power Button
2	Reset Button
3	Power LED
4	Device Activity LED
5	LAN1 LED & LAN2 LED
6	Information LED

Informational LED	
Status	Description
Continuously on and red	An overheat condition has occurred. (This may be caused by cable congestion.)
Blinking red (1Hz)	Fan failure, check for an inoperative fan.
Blinking red (0.25Hz)	Power failure, check for a non-operational power supply.
Solid blue	Local UID has been activated. Use this function to locate the server in a rack mount environment.
Blinking blue (300 mSEC)	Remote UID is on. Use this function to identify the server from a remote location.

Drive bay Installation/Removal

Installing a 3.5" SATA Drive

1. Power down the system and unplug the AC power cord.
2. Remove the chassis cover as described.
3. Use screws to secure the drive directly into the left side of the chassis as shown in the figure.

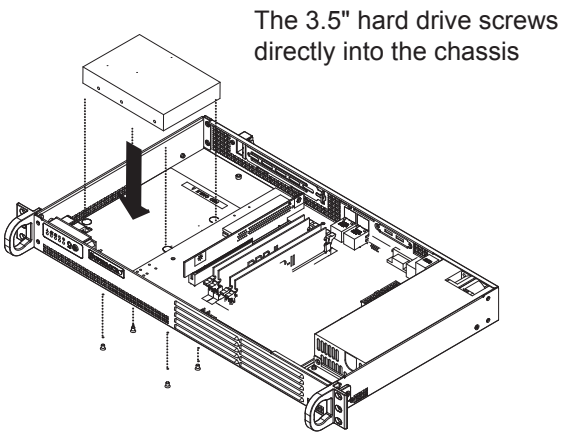

Installing 2.5" SATA Drives

1. Power down the system and unplug the AC power cord.
2. Remove the chassis cover.
3. Use screws to secure the drive into the hard drive bracket: For two drives the bracket is p/n MCP-220-00044-0N. For one drive the bracket is p/n MCP-220-00051-0N.
4. Use screws to secure the bracket/drive assembly into the left side of the chassis as shown in the figure.

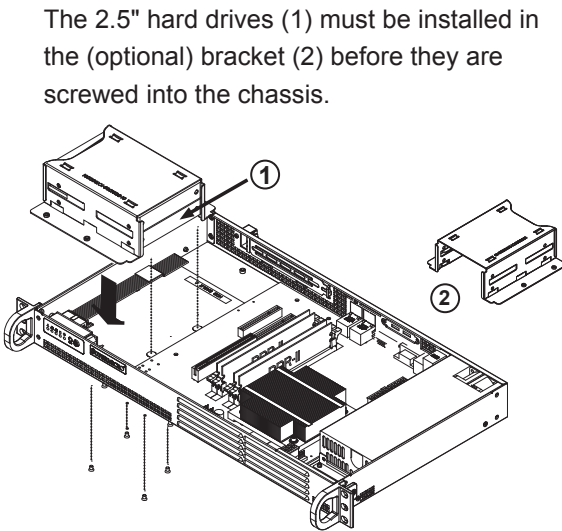

Caution

SAFETY INFORMATION
IMPORTANT: See installation instructions and safety warning before connecting system to power supply.
http://www.supermicro.com/about/policies/safety_information.cfm

WARNING:
To reduce risk of electric shock/damage to equipment, disconnect power from server by disconnecting all power cords from electrical outlets.
If any CPU socket empty, install protective plastic CPU cap

CAUTION:
Always be sure all power supplies for this system have the same power output. If mixed power supplies are installed, the system will not operate.

For more information go to :
<http://www.supermicro.com/support>

