

# SUPERMICR SuperServer 110P-WR/WTR Quick Reference Guide

## Board Layout

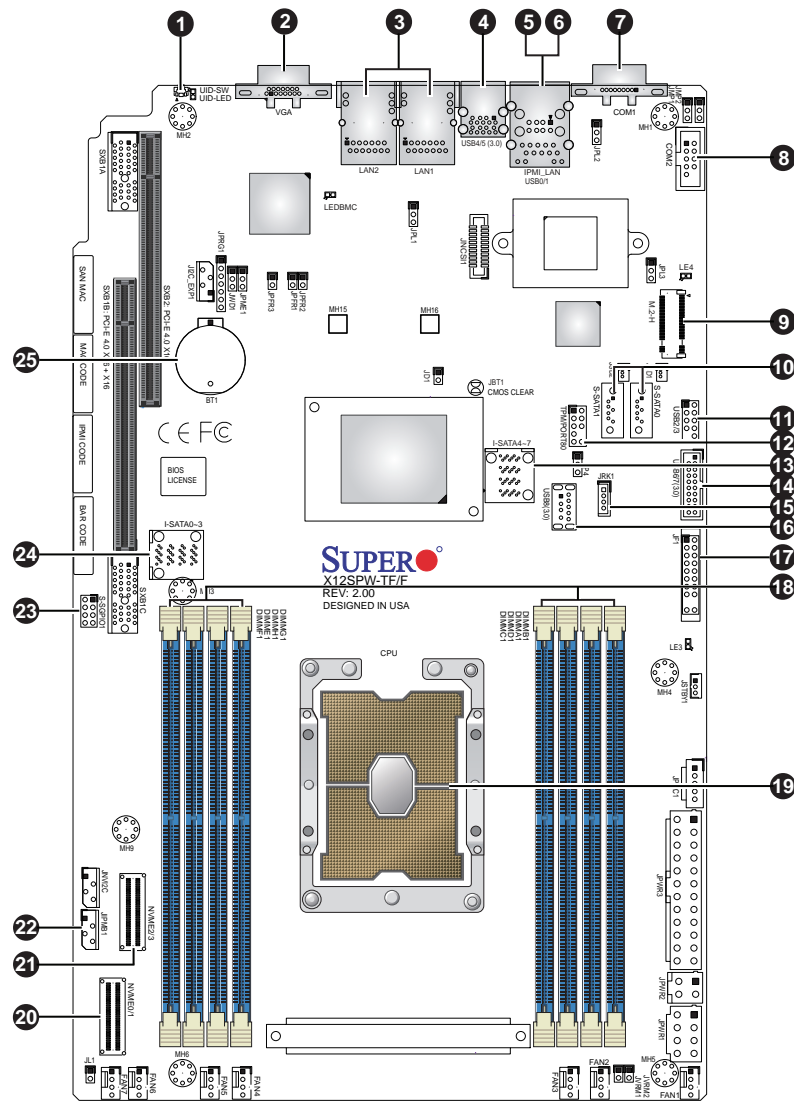

Item	Description
1	UID Button (Unit Identifier Button)
2	VGA Port
3	Two 10GbE(-TF)/1GbE(-F) LAN Ports
4	USB 3.2 Gen1 Port
5	Dedicated LAN for IPMI
6	USB 2.0 Port
7	COM Port (Serial Port)
8	COM Port Header (Serial Port)
9	M.2 PCI-E/SATA Interface
10	S-SATA0/1: SATA 3.0 Ports with SATA DOM Power
11	USB 2.0 Header
12	TPM Header
13	I-SATA4-7: Internal SATA Ports

Item	Description
14	USB 3.2 Gen1 Header
15	Intel RAID Key Header
16	USB 3.2 Gen1 Type-A Port
17	Front Control Panel Header
18	DIMM A1-H1 Slots
19	CPU
20	NVME0/1: PCI-E 4.0 x8 Slimline SAS Connector
21	NVME2/3: PCI-E 4.0 x8 Slimline SAS Connector
22	JIPMB1 4-pin BMC External I2C Header
23	S-SGPIO Header
24	I-SATA0-3: Internal SATA Ports
25	Onboard CMOS Battery

## Front View and Features

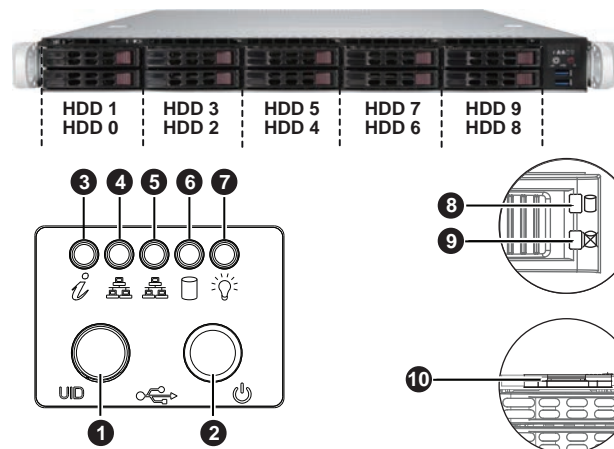

Control Panel Features	
Item	Description
1	UID Button
2	Power Button
3	Universal Information LED
4	NIC2 LED
5	NIC1 LED
6	HDD LED
7	Power LED
8	Drive Activity LED
9	Drive Status LED
10	Service/Asset Tag (pull-out identifier with BMC_ADMIN default password underneath)

## Rear View and Features

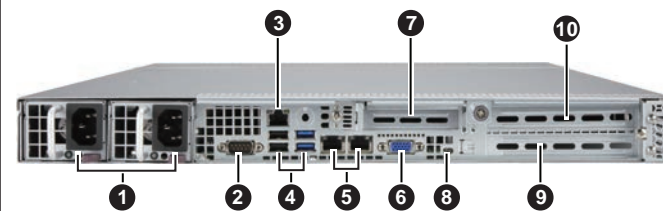

Item	Description
1	Redundant Power Supply Modules
2	Serial Port
3	Dedicated LAN for IPMI
4	Two USB 3.2 (blue) and Two USB 2.0 (black) Ports
5	LAN 1 (left) and LAN 2 (right) Ports
6	VGA Port
7	PCI-E 4.0 x16 Expansion Slot 3 (LP)
8	UID (Unit Identifier) Button
9	PCI-E 4.0 x16 Expansion Slot 2 (FHFL)
10	PCI-E 4.0 x16 Expansion Slot 1 (FHFL)

## BMC Password Label

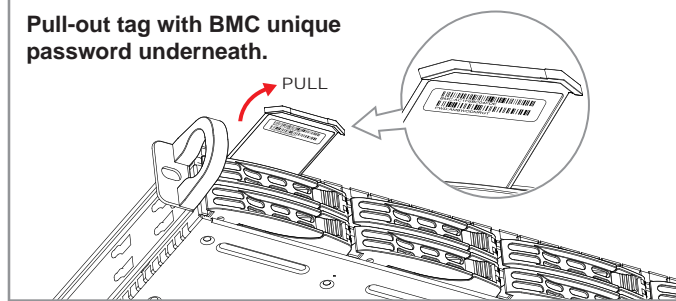

Each system comes with a unique default password for the ADMIN user. This can be found on a sticker on the motherboard and a sticker underneath the service tag on chassis. If necessary, the password can be reset by the Supermicro IPMICFG tool.

For more information, please visit <https://www.supermicro.com/en/solutions/management-software/bmc-resources>

## Memory

### DIMM Installation

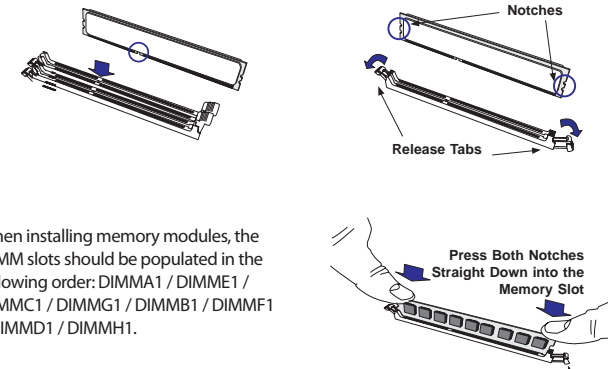

When installing memory modules, the DIMM slots should be populated in the following order: DIMMA1 / DIMME1 / DIMMC1 / DIMMG1 / DIMMB1 / DIMMF1 / DIMMD1 / DIMMH1.

- Always use DDR4 DIMM modules of the same type, size, and speed.
- Mixed DIMM speeds can be installed. However, all DIMMs will run at the speed of the slowest DIMM.
- The motherboard will support odd-numbered modules (3, 5, or 7 modules installed). However, to achieve the best memory performance, fully populated the motherboard with validated memory modules.

1 CPU, 8-DIMM Slots	
Number of DIMMs	Memory Population Sequence
1	DIMMA1
2	DIMMA1 / DIMME1
3	DIMMA1 / DIMME1 / DIMMC1
4	DIMMA1 / DIMME1 / DIMMC1 / DIMMG1
5	DIMMA1 / DIMME1 / DIMMC1 / DIMMG1 / DIMMB1
6	DIMMA1 / DIMME1 / DIMMC1 / DIMMG1 / DIMMB1 / DIMMF1
7	DIMMA1 / DIMME1 / DIMMC1 / DIMMG1 / DIMMB1 / DIMMF1 / DIMMD1
8	DIMMA1 / DIMME1 / DIMMC1 / DIMMG1 / DIMMB1 / DIMMF1 / DIMMD1 / DIMMH1

## CPU Installation and Removal

Supports a single Intel Xeon Ice Lake Scalable Processor (LGA 4189)

- A. Creating the Intel Ice Lake Carrier Assembly**
1. Locate small gold triangle (Pin 1) on processor and corresponding hollowed triangle on carrier.
  2. Using the triangles as a guide, carefully align and place Point A of the processor into the carrier. Gently snap into place to fasten onto Point B.

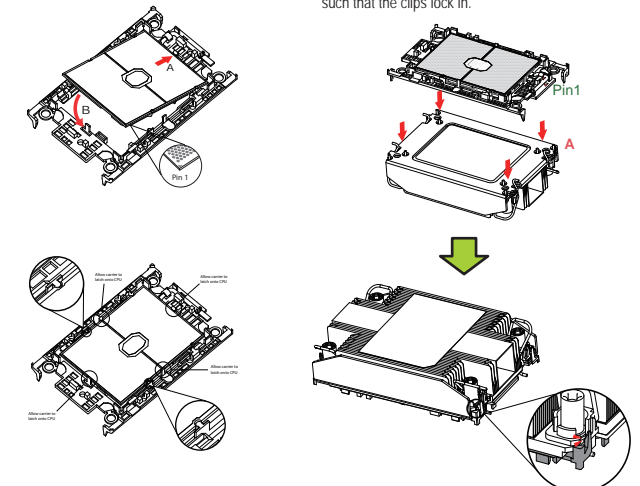

- C. Preparing the CPU Socket for Installation**
- Gently pull off the plastic protective cover by one corner to remove it from the CPU socket.

- D. Installing the Processor Heatsink Module**
1. Align the golden triangle (Pin 1) of the processor with the printed triangle on the socket. All four holes should be aligned.
  2. Ensure that the four rotating wires are in an "up" (unlocked) position.
  3. Mount the PHM onto the CPU socket on the motherboard and gently press into place. Flip the rotating wires to the sides to a locked position.
  4. With a T30 Torx-bit screwdriver, gently tighten peak nuts 1-4 in the order described on the heatsink label.

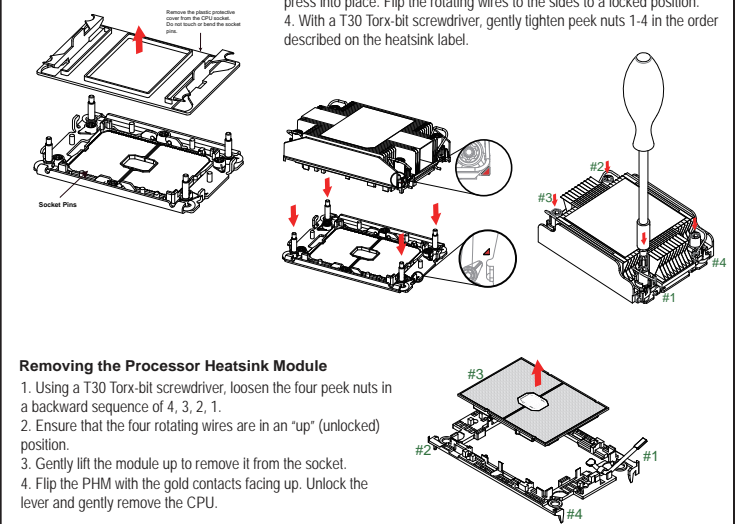

### Removing the Processor Heatsink Module

1. Using a T30 Torx-bit screwdriver, loosen the four peak nuts in a backward sequence of 4, 3, 2, 1.
2. Ensure that the four rotating wires are in an "up" (unlocked) position.
3. Gently lift the module up to remove it from the socket.
4. Flip the PHM with the gold contacts facing up. Unlock the lever and gently remove the CPU.

## Caution

**SAFETY INFORMATION**  
IMPORTANT: See installation instructions and safety warning before connecting system to power supply.  
[http://www.supermicro.com/about/policies/safety\\_information.cfm](http://www.supermicro.com/about/policies/safety_information.cfm)

**WARNING:**  
To reduce risk of electric shock/damage to equipment, disconnect power from server by disconnecting all power cords from electrical outlets. If any CPU socket empty, install protective plastic CPU cap

**WARNING:**  
Always be sure all power supplies for this system have the same power output. If mixed power supplies are installed, the system will not operate.

For more information go to : <http://www.supermicro.com/support>

