

# SUPERMICR<sup>®</sup> A+ Server AS -2024S-TR Quick Reference Guide

## Board Layout

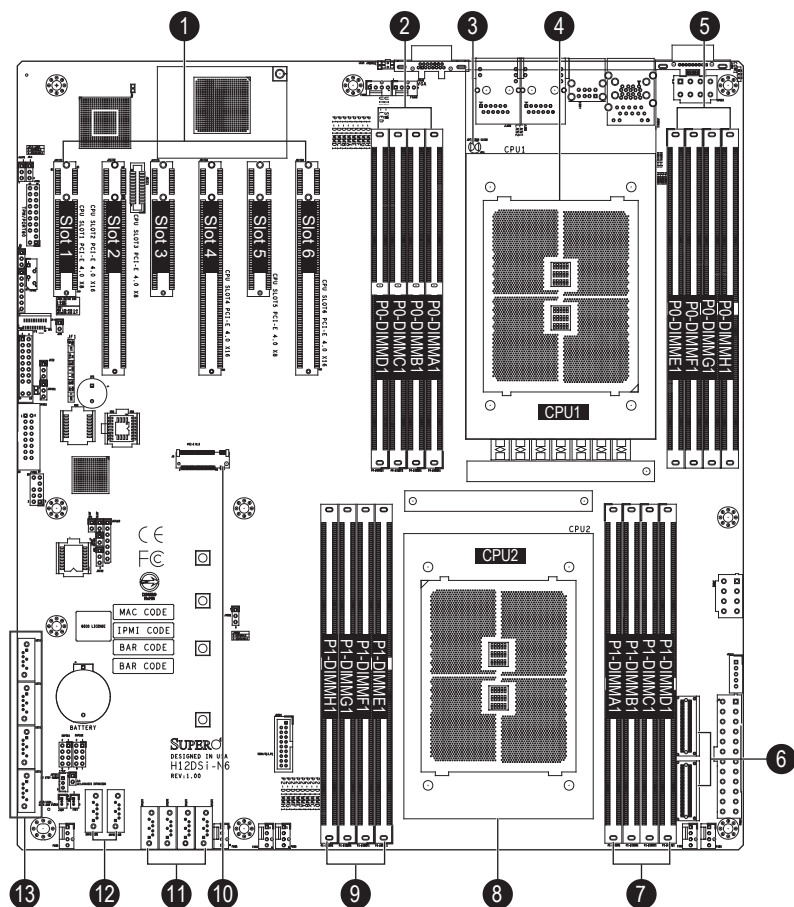

No.	Description
1	Slot1- Slot6: PCIe Expansion Card Slots
2	P0-DIMMA1~P0-DIMMD1 Slots (P0 slots: CPU1)
3	JBT1: CMOS Clear
4	CPU1
5	P0-DIMME1~P0-DIMMH1 Slots (P0 slots: CPU1)
6	CN1~2: NVMe Ports
7	P1-DIMMA1~P1-DIMMD1 Slots (P1 slots: CPU2)
8	CPU2
9	P1-DIMME1~P1-DIMMH1 Slots (P1 slots: CPU2)
10	PCIe M.2: M.2 Connector
11	SATA4-7: Onboard SATA3 Ports
12	SUPERDOM1/2: SATA3 DOM Ports (6Gb/s)
13	SATA0-3: Onboard SATA3 Ports

## Air Shroud Installation

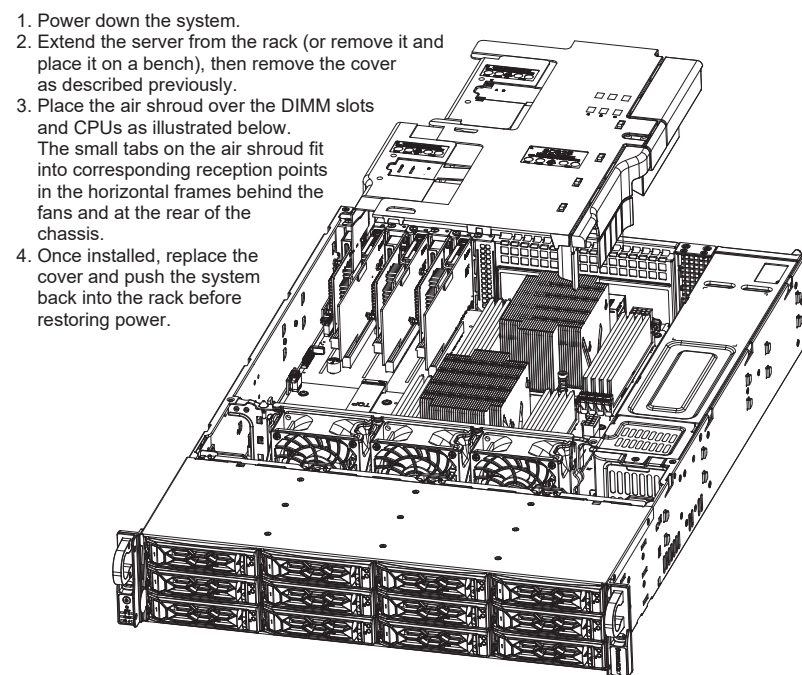

- Power down the system.
- Extend the server from the rack (or remove it and place it on a bench), then remove the cover as described previously.
- Place the air shroud over the DIMM slots and CPUs as illustrated below. The small tabs on the air shroud fit into corresponding reception points in the horizontal frames behind the fans and at the rear of the chassis.
- Once installed, replace the cover and push the system back into the rack before restoring power.

## Front View & Interface

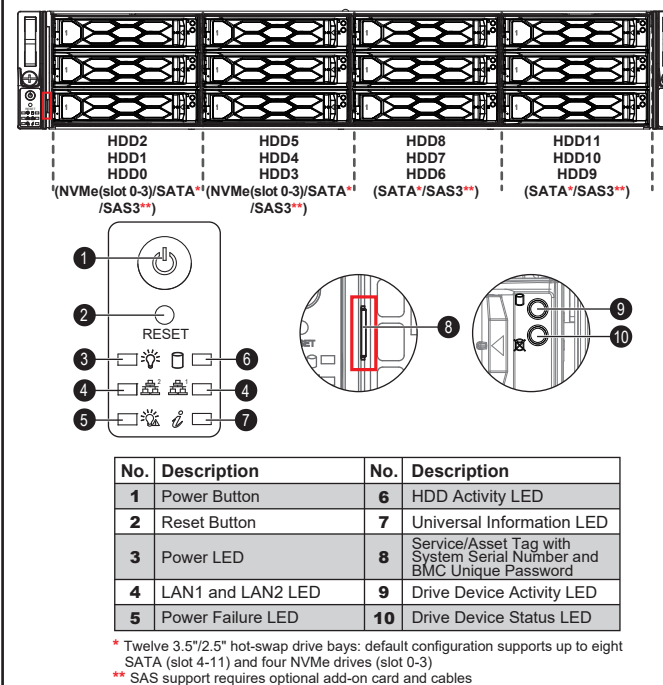

No.	Description	No.	Description
1	Power Button	6	HDD Activity LED
2	Reset Button	7	Universal Information LED
3	Power LED	8	Service/Asset Tag with System Serial Number and BMC Unique Password
4	LAN1 and LAN2 LED	9	Drive Device Activity LED
5	Power Failure LED	10	Drive Device Status LED

\* Twelve 3.5"/2.5" hot-swap drive bays: default configuration supports up to eight SATA (slot 4-11) and four NVMe drives (slot 0-3)  
 \*\* SAS support requires optional add-on card and cables

## Rear View

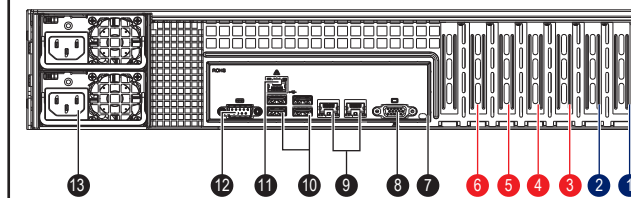

No.	Description
1	PCI-E 4.0 x8 Slot (LP)
2	PCI-E 4.0 x16 Slot (LP)
3	PCI-E 4.0 x8 Slot (LP)
4	PCI-E 4.0 x16 Slot (LP)
5	PCI-E 4.0 x8 Slot (LP)
6	PCI-E 4.0 x16 Slot (LP)
7	UID LED (Unit Identifier Button)
8	VGA Port
9	2x LAN Ports
10	USB 0/1/2/3 Ports
11	Dedicated LAN for IPMI
12	COM Port
13	Redundant Power Supply Modules

## Memory

### Memory Support

The AS -2024S-TR supports up to 4TB of registered ECC DDR4-3200 SDRAM in 16 DIMM slots. Refer to the table below for additional memory information.

Processors and their Corresponding Memory Modules									
Channel									
CPU#	D1	C1	B1	A1	CPU	E1	F1	G1	H1
2 DIMMs (Not Recommended)									
CPU1		✓			CPU				
CPU2		✓			CPU				
4 DIMMs (Not Recommended)									
CPU1	✓	✓			CPU				
CPU2	✓	✓			CPU				
8 DIMMs									
CPU1	✓	✓			CPU			✓	✓
CPU2	✓	✓			CPU			✓	✓
12 DIMMs (for 7003 CPU only)									
CPU1	✓	✓		✓	CPU	✓		✓	✓
CPU2	✓	✓		✓	CPU	✓		✓	✓
16 DIMMs									
CPU1	✓	✓	✓	✓	CPU	✓	✓	✓	✓
CPU2	✓	✓	✓	✓	CPU	✓	✓	✓	✓

NOTE: To achieve optimal memory performance, the minimum recommended is at least one DIMM for each channel pair in the system (e.g., A, C, E, G).

## CPU Installation

### Processor Installation

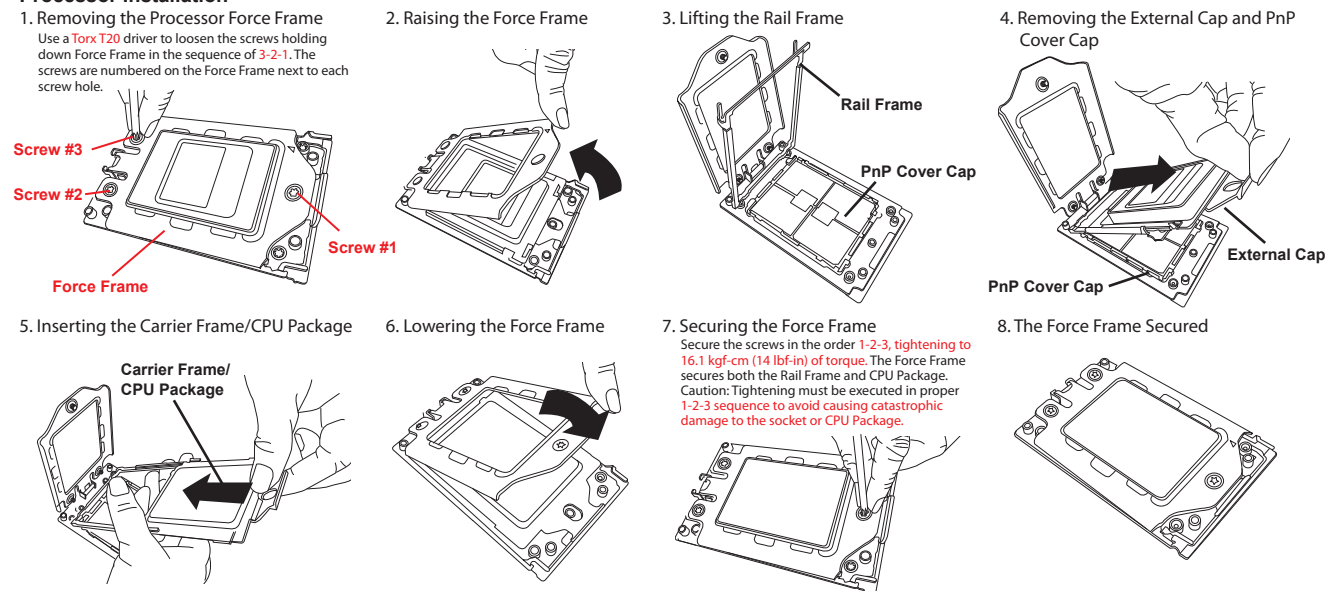

## Hard Drive Installation

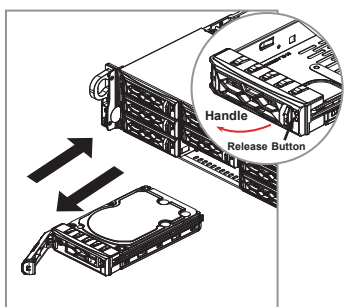

### Removing a Hot-Swap Drive Carrier from the Chassis

- Press the release button on the drive carrier, which will extend the drive carrier handle.
- Use the drive carrier handle to pull the drive out of the chassis.

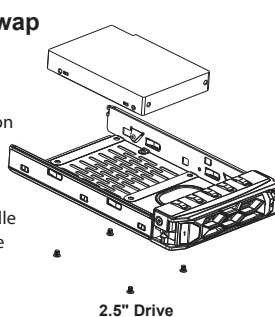

2.5" Drive

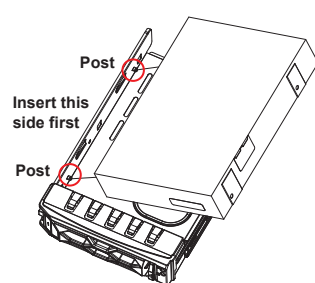

3.5" Drive

### Installing a 3.5" Drive

- Position the drive above the carrier with the PCB side facing down and the connector end toward the rear of the carrier.
- Tilt the drive to insert it onto the two posts on the left inside of the carrier.
- Push the right side of the drive fully into the carrier and allow the two spring locking clasps to secure the drive.
- Insert the drive carrier into its bay, keeping the release button on the right. When the carrier reaches the rear of the bay, the release handle will retract.
- Push the handle in until it clicks into its locked position

### Installing a 2.5" Drive

- Install the drive directly into the tray with four screws underneath.
- Insert the drive carrier into its bay, keeping the release button on the right. When the carrier reaches the rear of the bay, the release handle will retract.
- Push the handle in until it clicks into its locked position

## Heatsink Installation

### 1. Mounting the Heatsink

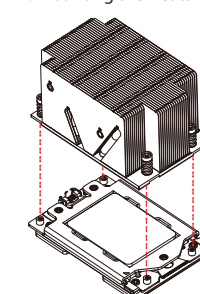

### 2. Securing the Heatsink

Using a diagonal pattern and a Torx T20 driver, tighten the four heatsink screws evenly to 16.1 kgf-cm (14.0 lbf-in) torque.

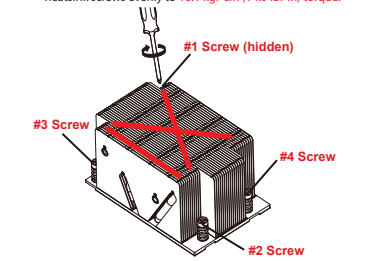

## Caution

**SAFETY INFORMATION**  
 IMPORTANT: See installation instructions and safety warning before connecting system to power supply.  
[http://www.supermicro.com/about/policies/safety\\_information.cfm](http://www.supermicro.com/about/policies/safety_information.cfm)

**WARNING:**  
 To reduce risk of electric shock/damage to equipment, disconnect power from server by disconnecting all power cords from electrical outlets. If any CPU socket empty, install protective plastic CPU cap

**WARNING:**  
 Always be sure all power supplies for this system have the same power output. If mixed power supplies are installed, the system will not operate. For more information go to : <http://www.supermicro.com/support>

