

SUPERMICR® GrandTwin A+ Server® AS-2116GT-HNTF Quick Reference

MNL-2777-QRG-100
© 2025 Supermicro Computer Inc. All rights reserved. Reproduction of this document whether in part or in whole is strictly prohibited without Supermicro's written consent. All trademarks are property of their respective entities. All information provided is deemed accurate at the time of printing. However, it is not guaranteed.

Board Layout

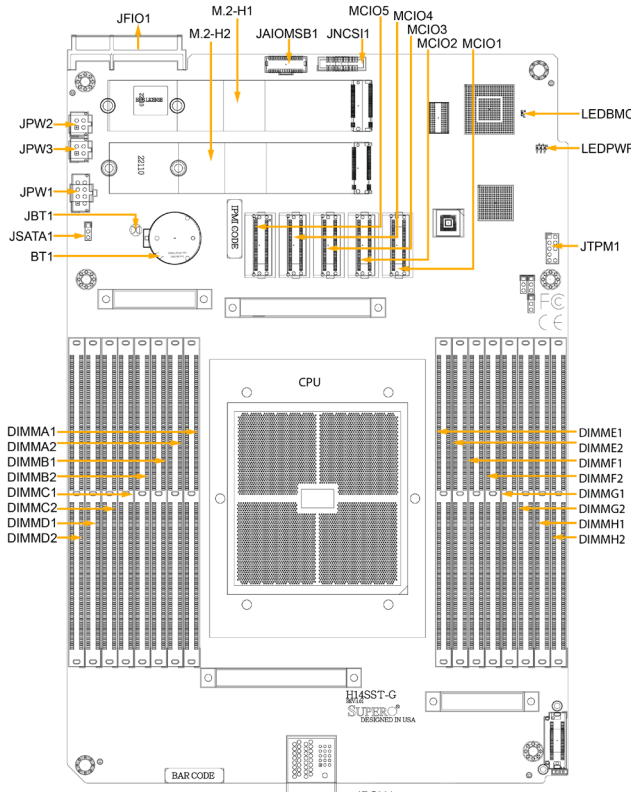

Jumper	Description	Default Setting
JBT1	CMOS Clear	Open (Normal)
JSATA1	Hybrid MCI05 select	Plins 2-3 (SATA)
LED	Description	Status
LEDBMC	BMC Heartbeat LED	Green Blinking: BMC Normal Green Blinking Fast: BMC Initializing
LEDPWR	Power LED	Solid Green: Power On
Connector	Description	
BT1	Onboard Battery	
DIMMA1-DIMMD2	Memory Slots	
DIMME1-DIMMH2	Memory Slots	
JAIOMSB1	Sideband Signals Header	
JFIO1	GrandTwin Front IPMI and Onboard NIC Module Connector	
MCI01-JMCI05	MCI0 Connectors	
JNCIS1	NCSI Connector	
JPSU1	Power Supply Module Connector	
JPW1	12 V / 5 V 8-pin Power Connector for SATA Backplane	
JPW2-JPW3	12 V 4-pin Power Connectors for NVMe BackPlane, AIOM Adapter and internal PCIe Riser Card	
JSATA1	Signal Switch for MCI05 (SATA or NVMe)	
JTPM1	Trusted Platform Module/Port 80 Connector	
M.2-H1, M.2-H2	M.2 NVMe or SATA SSDs	

Memory

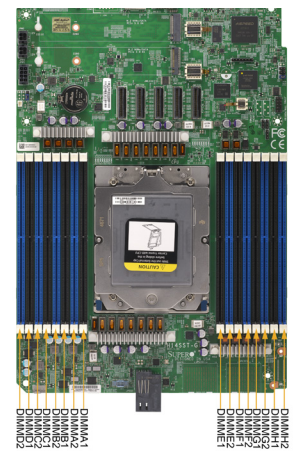

DIMM Module Population

- It is recommended to use DDR5 memory of the same type, size and speed.
- Mixed DIMM speeds can be installed. However, all DIMMs will run at the speed of the slowest DIMM.
- The motherboard will support odd-numbered modules. However, to achieve the best memory performance, fully populate the motherboard with validated memory modules.

Follow the below table for installing memory modules.

Type	DIMM Population		Maximum Frequency (MT/s)
	DIMM0	DIMM1	
RDIMM	N/A	1R	4800
	1R	1R	4000
	N/A	2R	4800
	2R	2R	3600
3DS RDIMM	N/A	2S2R (4 ranks)	4800
	2S2R (4 ranks)	2R (2 ranks)	3600
	N/A	2S4R (8 ranks)	4800
	2S4R (8 ranks)	2S4R (8 ranks)	3600

Type	DIMM Population		Maximum Frequency (MT/s)		
	DIMM0	DIMM1	6400 MT/s Grade DIMM	5600 MT/s Grade DIMM	4800 MT/s Grade DIMM
RDIMM	N/A	1R	5200	4800	4800
	1R	1R	4400	4000	4000
	N/A	2R	5200	4800	4800
	2R	2R	4000	3600	3600
3DS RDIMM	N/A	2S2R (4 ranks)	5200	4800	4800
	2S2R (4 ranks)	2S2R (4 ranks)	4000	3600	3600
	N/A	2S4R (8 ranks)	5200	4800	4800
	2S4R (8 ranks)	2S4R (8 ranks)	4000	3600	3600

Channel	DIMM Population Guide															
	DIMM Slot															
	D2	D1	C2	C1	B2	B1	A2	A1	E1	E2	F1	F2	G1	G2	H1	H2
CPU1 & 1 DIMM							V									
CPU1 & 2 DIMMs							V			V						
CPU1 & 4 DIMMs			V				V			V				V		
CPU1 & 6 DIMMs			V	V		V	V			V			V	V		
CPU1 & 8 DIMMs	V		V	V	V	V	V			V			V	V	V	
CPU1 & 12 DIMMs	V	V	V	V	V	V	V	V	V	V	V	V	V	V	V	V
CPU1 & 16 DIMMs	V	V	V	V	V	V	V	V	V	V	V	V	V	V	V	V

Hard Drive Installation

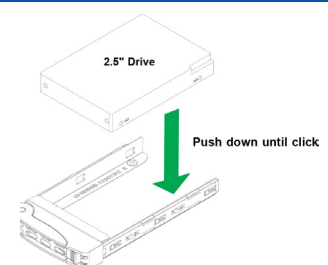
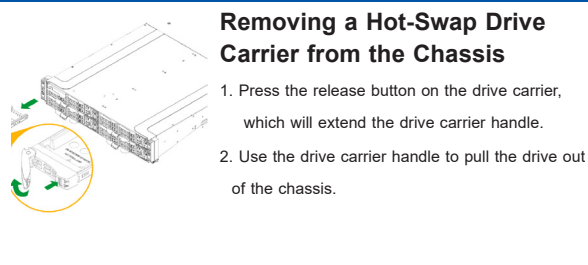

- Removing a Hot-Swap Drive Carrier from the Chassis**
- Press the release button on the drive carrier, which will extend the drive carrier handle.
 - Use the drive carrier handle to pull the drive out of the chassis.
- Installing a Drive**
- Insert the drive carrier with the disk drive into its bay, keeping the carrier oriented so that the release button is on the right side. When the carrier reaches the rear of the bay, the release handle retracts.
 - Push the handle in until it clicks into its locked position.

Front View & Interface

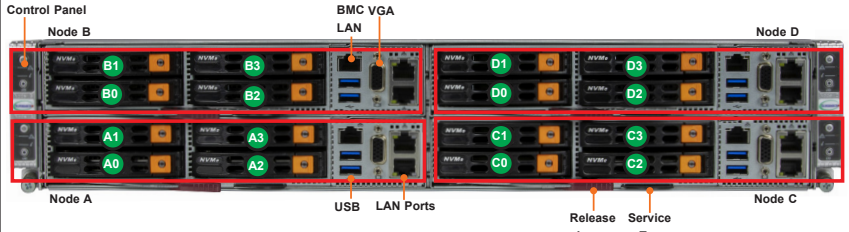

Feature	Description
Control Panel	Four labeled control panels (one per node)
Service Tag	Four pull-out service tags with BMC password labels (one per node)
Drive Bays	16 hot-swappable drive bays (four per node) (optional)
BMC LAN Port	Four BMC dedicated LAN ports (one per node)
USB Ports	Eight USB 3.0 ports (two per node)
VGA Ports	Four video ports (one per node)
LAN Ports	LAN integrated network connections (LAN port quantity dependent on GrandTwin I/O configuration)
Release Levers	Four levers supporting node tray removal (one per node)
Thumbscrews	Two thumbscrews to secure the server onto the rack

CPU Installation

- Remove the Processor Force Frame
- Raise the Force Frame
- Lifting the Rail Frame
- Remove the External Cap

Remove the screw holding down the force frame. The spring-loaded force frame will raise up. Allow it to lift up to its stopped position.

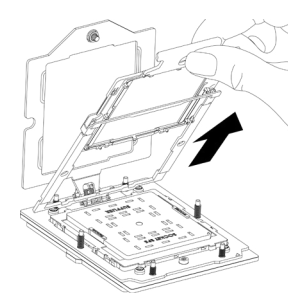
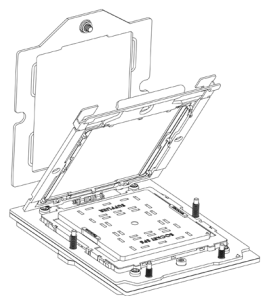
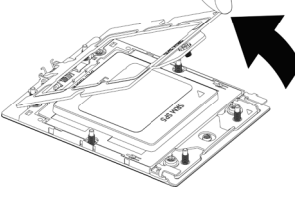
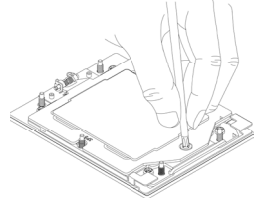

- Insert the Carrier Frame/Processor
- Lower the Force Frame
- Secure the Force Frame

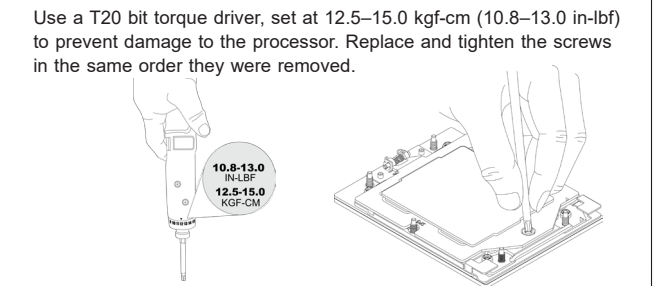
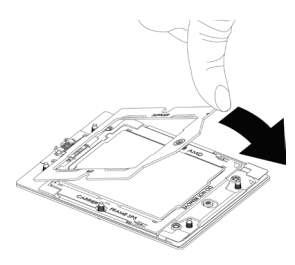
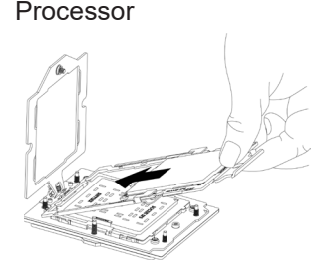

Heatsink Installation

- Mount the Heatsink
- Securing the Heatsink

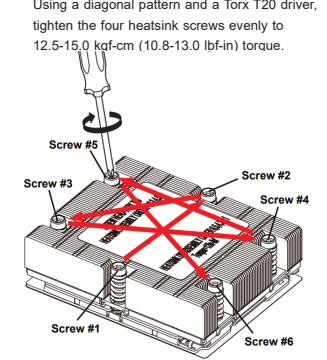
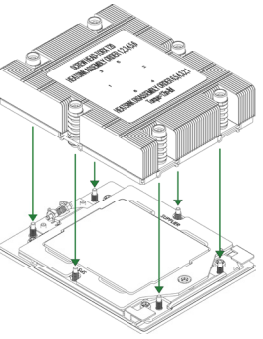

System Information

Each system comes with a unique default password for the ADMIN user. This can be found on a sticker on the motherboard and another on the chassis service tag. If necessary, the password can be reset. For more information, please visit <https://www.supermicro.com/en/solutions/management-software/bmc-resources>

SAFETY INFORMATION
IMPORTANT: See installation instructions and safety warning before connecting system to power supply. https://www.supermicro.com/about/policies/safety_inforation.cfm

WARNING
To reduce risk of electrical shock/damage to equipment, disconnect power from server by disconnecting all power cords from electrical outlets. If any CPU socket is empty, install protective plastic CPU cap.

CAUTION
Always be sure all power supplies for this system have the same power output. If mixed power supplies are installed, the system will not operate. For more information, go to <https://www.supermicro.com/support>



Scan for product landing page.