

SUPERMICR SuperServer 7047R-72RF/72RFT Quick Reference Guide

Board Layout

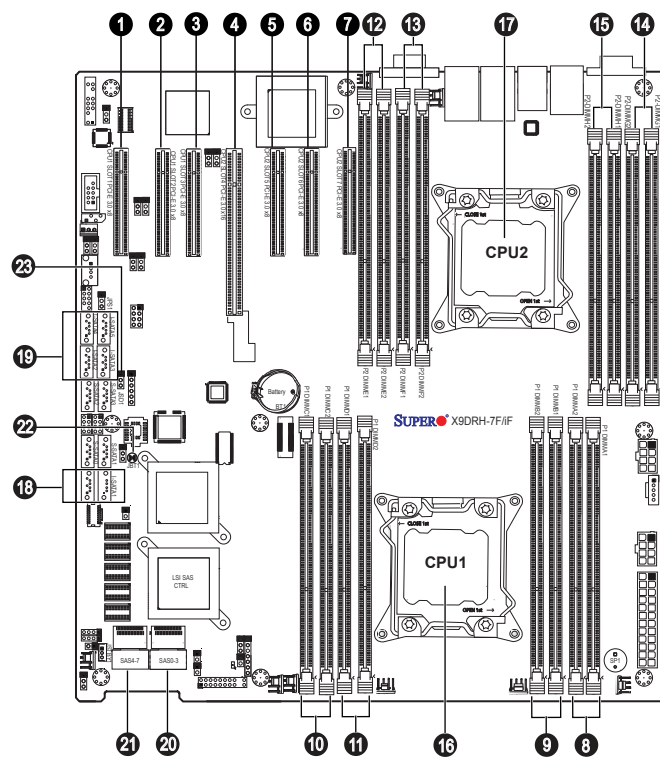

No.	Description
1	CPU1 Slot1 PCI-E 3.0 x8
2	CPU1 Slot2 PCI-E 3.0 x8
3	CPU1 Slot3 PCI-E 3.0 x8
4	CPU2 Slot4 PCI-E 3.0 x16
5	CPU2 Slot5 PCI-E 3.0 x8
6	CPU2 Slot6 PCI-E 3.0 x8
7	CPU2 Slot7 PCI-E 3.0 x8
8	DIMMA1 (Blue)/DIMMA2 slot
9	DIMMB1 (Blue)/DIMMB2 slot
10	DIMMC1 (Blue)/DIMMC2 slot
11	DIMMD1 (Blue)/DIMMD2 slot
12	DIMME1 (Blue)/DIMME2 slot
13	DIMMF1 (Blue)/DIMMF2 slot
14	DIMMG1 (Blue)/DIMMG2 slot
15	DIMMH1 (Blue)/DIMMH2 slot
16	CPU1 (Install CP1 first)
17	CPU2
18	(I-)SATA 0/1 SATA 3.0 Ports 0/1 (Available for RAID 0, RAID 1 only, used in conjunction with T-SPGIO1)
19	(I-)SATA 2/5 Intel SB SATA 2.0 Connectors: 2/4 (T-SGPIO1) and 4/5 (T-SGPIO2) Available for RAID 0, 1, 5, 10)
20	SAS #0 ~ #3 Ports
21	SAS #4 ~ #7 Ports
22	JBT1 = Clear CMOS
23	JSD1 = SATA Device Power Connector

MEMORY

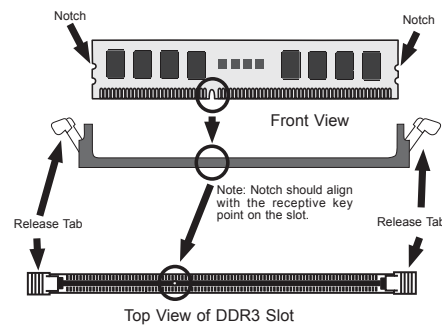

Processors and their Corresponding Memory Modules												
CPU#	Corresponding DIMM Modules											
CPU 1	A1	A2	A3	B1	B2	B3	C1	C2	C3	D1	D2	D3
CPU 2	E1	E2	E3	F1	F2	F3	G1	G2	G3	H1	H2	H3

Processors and Memory Module Population for Optimal Performance	
Number of CPUs + DIMMs	CPU and Memory Population Configuration Table (For memory to work properly, follow the instructions below)
1 CPU & 2 DIMMs	CPU1 & P1-DIMMA1/P1-DIMMB1
1 CPU & 4 DIMMs	CPU1 & P1-DIMMA1/P1-DIMMB1, P1-DIMMC1/P1-DIMMD1
1 CPU & 5-8 DIMMs	CPU1 & P1-DIMMA1/P1-DIMMB1, P1-DIMMC1/P1-DIMMD1, P1-DIMMA2/P1-DIMMB2, P1-DIMMC2/P1-DIMMD2
2 CPUs & 4 DIMMs	CPU1 + CPU2 & P1-DIMMA1/P1-DIMMB1, P2-DIMME1/P2-DIMMF1
2 CPUs & 6 DIMMs	CPU1 + CPU2 & P1-DIMMA1/P1-DIMMB1, P2-DIMME1/P2-DIMMF1, P1-DIMMC1/P1-DIMMD1
2 CPUs & 8 DIMMs	CPU1 + CPU2 & P1-DIMMA1/P1-DIMMB1, P2-DIMME1/P2-DIMMF1, P1-DIMMC1/P1-DIMMD1, P2-DIMMG1/P2-DIMMH1
2 CPUs & 9-12 DIMMs	CPU1 + CPU2 & P1-DIMMA1/P1-DIMMB1, P2-DIMME1/P2-DIMMF1, P1-DIMMC1/P1-DIMMD1, P2-DIMMG1/P2-DIMMH1, P1-DIMMA2/P1-DIMMB2, P2-DIMME2/P2-DIMMF2
2 CPUs & 13-24 DIMMs	CPU1 + CPU2 & P1-DIMMA1/P1-DIMMB1, P2-DIMME1/P2-DIMMF1, P1-DIMMC1/P1-DIMMD1, P2-DIMMG1/P2-DIMMH1, P2-DIMMA2/P2-DIMMB2, P2-DIMME2/P2-DIMMF2, P1-DIMMC2/P1-DIMMD2, P2-DIMMG2/P2-DIMMH2, P1-DIMMA3/P1-DIMMB3, P2-DIMME3/P2-DIMMF3, P1-DIMMC3/P1-DIMMD3, P2-DIMMG3/P2-DIMMH3

Installing UDIMM (ECC/non-ECC) Memory

Intel E5-2600 Series Processor UDIMM Memory Support							
Ranks per DIMM & Data Width	Memory Capacity Per DIMM (See the Note below)		Speed (MT/s) and Voltage Validated by Slot per Channel (SPC) and DIMM Per Channel (DPC)				
			3 Slots Per Channel				
			1DPC		2DPC		
			1.35V	1.5V	1.35V	1.5V	
SRx8 Non-ECC	1GB	2GB	4GB	NA	1066, 1333	NA	1066, 1333
DRx8 Non-ECC	2GB	4GB	8GB	NA	1066, 1333	NA	1066, 1333
SRx16 Non-ECC	512MB	1GB	2GB	NA	1066, 1333	NA	1066, 1333
SRx8 ECC	1GB	2GB	4GB	1066	1066, 1333	1066	1066, 1333
DRx8 ECC	2GB	4GB	8GB	1066	1066, 1333	1066	1066, 1333

Installing RDIMM (ECC) Memory

Intel E5-2600 Series Processor RDIMM Memory Support									
Ranks per DIMM & Data Width	Memory Capacity Per DIMM (See the Note below)		Speed (MT/s) and Voltage Validated by Slot per Channel (SPC) and DIMM Per Channel (DPC)						
			2 Slots Per Channel						
			1DPC		1DPC		2DPC		
			1.35V	1.5V	1.35V	1.5V	1.35V	1.5V	
SRx8	1GB	2GB	4GB	1066, 1333	1066, 1333, 1600	1066, 1333	1066, 1333, 1600	NA	800, 1066
DRx8	2GB	4GB	8GB	1066, 1333	1066, 1333, 1600	1066, 1333	1066, 1333, 1600	NA	800, 1066
SRx4	2GB	4GB	8GB	1066, 1333	1066, 1333, 1600	1066, 1333	1066, 1333, 1600	NA	800, 1066
DRx4	4GB	8GB	16GB	1066, 1333	1066, 1333, 1600	1066, 1333	1066, 1333, 1600	NA	800, 1066
QRx4	8GB	16GB	32GB	800	1066	800	800	NA	NA
QRx8	4GB	8GB	16GB	800	1066	800	800	NA	NA

Installing LRDIMM (ECC) Memory

Intel E5-2600 Series Processor LRDIMM Memory Support							
Ranks per DIMM & Data Width	Memory Capacity Per DIMM (See the Note below)		Speed (MT/s) and Voltage Validated by Slot per Channel (SPC) and DIMM Per Channel (DPC)				
			3 Slots Per Channel				
			1DPC and 2DPC		3DPC		
			1.35V	1.5V	1.35V	1.5V	
QRx4 (DDP)	16GB	32GB	1066	1066, 1333	1066	1066	
QRx8 (P)	8GB	16GB	1066	1066, 1333	1066	1066	

Note: For detailed information on memory support and updates, please refer to the SMC Recommended Memory List posted on our website at <http://www.supermicro.com/support/resources/mem.cfm>.

Front View & Interface

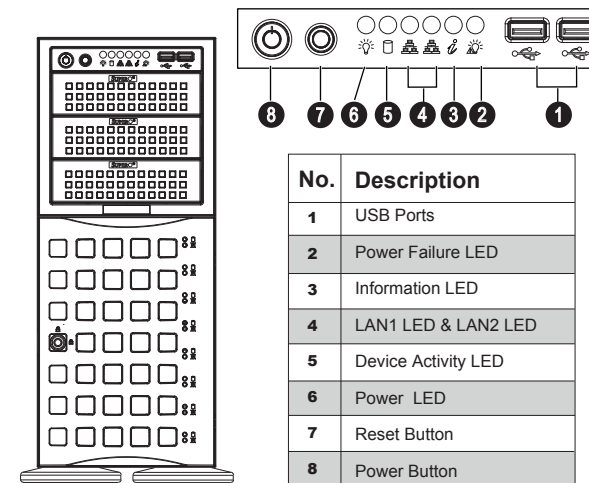

Rotating the Storage Module

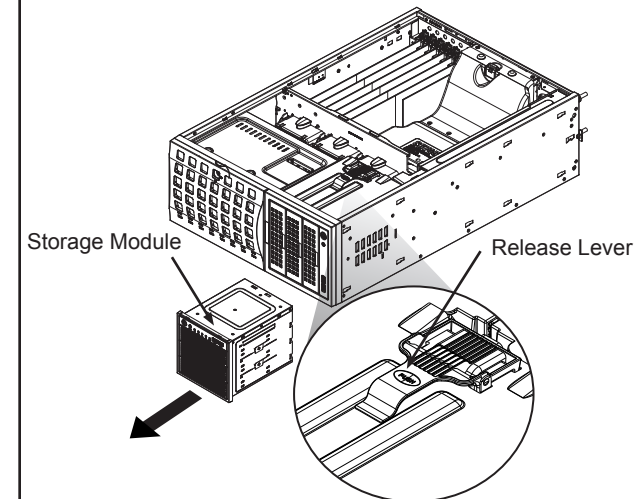

Rotating the Storage Module for Rack Mounting

1. Open the chassis cover.
2. Locate the storage module and disconnect any cables from the storage module to any component in the chassis.
3. Push the storage module release lever. This lever unlocks the storage module
4. Grasp the external edges of the storage module and pull the unit from the chassis
5. Turn the storage module 90 degrees
6. Reinsert the module into the chassis and reconnect the cords

Beep Codes

BIOS Beep Codes		
Beep Code/LED	Message	Description
1 beep	Refresh	Circuits have been reset. (Ready to power up)
5 short beeps + 1 long beep	Memory	No memory detected
5 long beeps + 2 short beeps	Display memory read/write status	Video adapter missing or with faulty memory
1 continuous beep	System	System overheat

CPU Installation

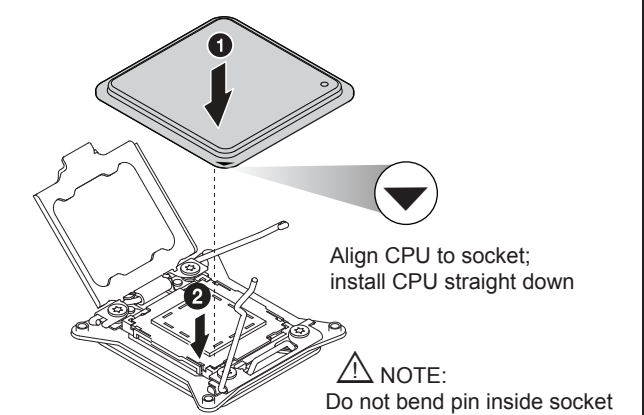

Heatsink Installation

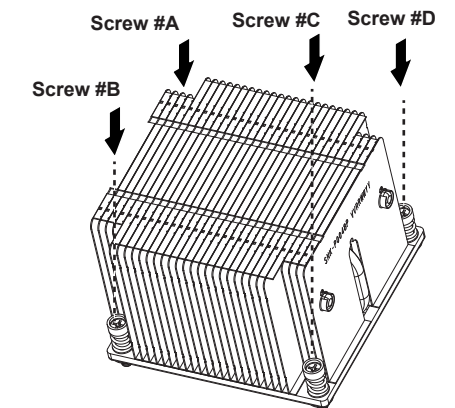

1. Place heatsink on top of installed CPU
2. Line up the four screws to socket
3. Push down heatsink and screw down as shown (cross pattern, in order: A, C, B, D)
4. NOTE: Only use 6-8 lb/f of torque; otherwise, hand-tighten each screw, to avoid damaging the system

Caution

SAFETY INFORMATION
IMPORTANT: See installation instructions and safety warning before connecting system to power supply.
http://www.supermicro.com/about/policies/safety_information.cfm

WARNING:
To reduce risk of electric shock/damage to equipment, disconnect power from server by disconnecting all power cords from electrical outlets.
If any CPU socket empty, install protective plastic CPU cap

CAUTION:
Always be sure all power supplies for this system have the same power output. If mixed power supplies are installed, the system will not operate.

For more information go to :
<http://www.supermicro.com/support>

