

Board Layout

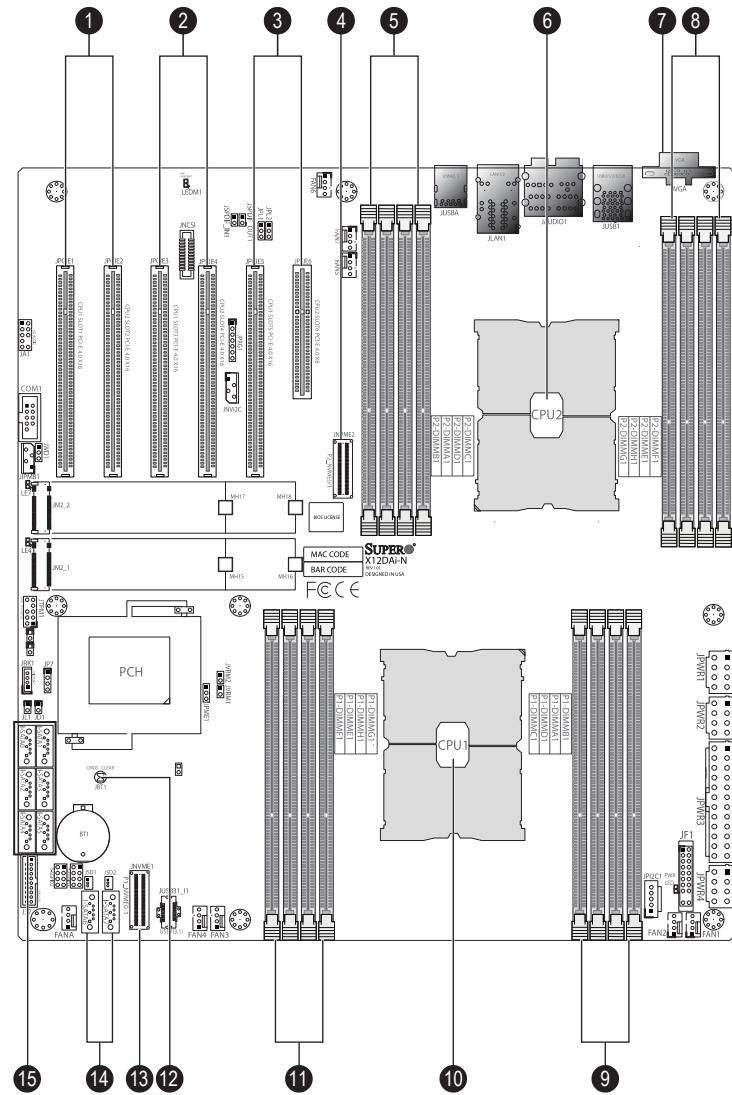

No.	Description
1	JPCIE1/2: CPU PCIe 4.0 x16 slots (slot1 supported by CPU1, slot2 supported by CPU2)
2	JPCIE3/4: CPU PCIe 4.0 x16 slots (slot3 supported by CPU1, slot4 supported by CPU2)
3	JPCIE5/6: CPU PCIe 4.0 x16 slot supported by CPU1, CPU PCIe 4.0 x8 slot supported by CPU2
4	JNVMe2: NVMe PCIe 4.0 x8 port
5	P2-DIMMC1/P2-DIMMD1/P2-DIMMA1/P2-DIMMB2 slots
6	CPU2
7	VGA
8	P2-DIMMF1/P2-DIMME1/P2-DIMMH1/P2-DIMMG1 slots
9	P1-DIMMB1/P1-DIMMA1/P1-DIMMD1/P1-DIMMC1 slots
10	CPU1
11	P1-DIMMG1/P1-DIMMH1/P1-DIMME1/P1-DIMMF1 slots
12	JBT1: CMOS Clear
13	JNVMe1: NVMe PCIe 4.0 x8 port
14	I-SATA6/7: SATA 3.0 connection headers with SATA DOM Power supported by the Intel PCH
15	I-SATA 0/1/2/3/4/5: SATA 3.0 connection headers supported by the Intel PCH

Memory Support

DDR4 Memory Population Table for X12DP 16-DIMM Motherboards

CPU/DIMMs	Memory Population Sequence
2 CPUs & 2 DIMMs*	CPU1: P1-DIMMA1 CPU2: P2-DIMMA1
2 CPUs & 4 DIMMs*	CPU1: P1-DIMMA1/P1-DIMME1 CPU2: P2-DIMMA1/P2-DIMME1
2 CPUs & 6 DIMMs	CPU1: P1-DIMMA1/P1-DIMME1/P1-DIMMC1/P1-DIMMG1 CPU2: P2-DIMMA1/P2-DIMME1
2 CPUs & 8 DIMMs*	CPU1: P1-DIMMA1/P1-DIMME1/P1-DIMMC1/P1-DIMMG1 CPU2: P2-DIMMA1/P2-DIMME1/P2-DIMMC1/P2-DIMMG1
2 CPUs & 10 DIMMs	CPU1: P1-DIMMA1/P1-DIMME1/P1-DIMMC1/P1-DIMMG1/P1-DIMMB1/P1-DIMMF1 CPU2: P2-DIMMA1/P2-DIMME1/P2-DIMMC1/P2-DIMMG1
2 CPUs & 12 DIMMs*	CPU1: P1-DIMMA1/P1-DIMME1/P1-DIMMC1/P1-DIMMG1/P1-DIMMB1/P1-DIMMF1 CPU2: P2-DIMMA1/P2-DIMME1/P2-DIMMC1/P2-DIMMG1/P2-DIMMB1/P2-DIMMF1
2 CPUs & 14 DIMMs	CPU1: P1-DIMMA1/P1-DIMME1/P1-DIMMC1/P1-DIMMG1/P1-DIMMB1/P1-DIMMF1/ P1-DIMMD1/P1-DIMMH1 CPU2: P2-DIMMA1/P2-DIMME1/P2-DIMMC1/P2-DIMMG1/P2-DIMMB1/P2-DIMMF1
2 CPUs & 16 DIMMs*	CPU1: P1-DIMMA1/P1-DIMME1/P1-DIMMC1/P1-DIMMG1/P1-DIMMB1/P1-DIMMF1/ P1-DIMMD1/P1-DIMMH1 CPU2: P2-DIMMA1/P2-DIMME1/P2-DIMMC1/P2-DIMMG1/P2-DIMMB1/P2-DIMMF1/ P2-DIMMD1/P2-DIMMH1

Note: This memory configuration is recommended by Supermicro for optimal memory performance. Please use this configuration to maximize your memory performance

Front view & Interface

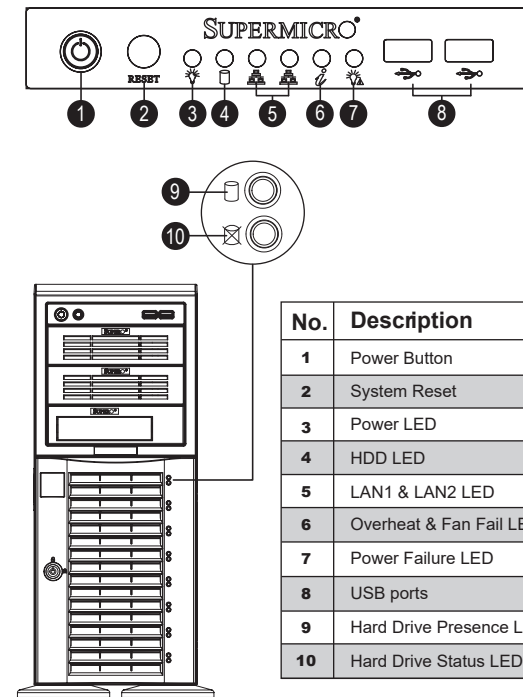

No.	Description
1	Power Button
2	System Reset
3	Power LED
4	HDD LED
5	LAN1 & LAN2 LED
6	Overheat & Fan Fail LED
7	Power Failure LED
8	USB ports
9	Hard Drive Presence LED
10	Hard Drive Status LED

Storage Module

Configuring the Storage Module for 5.25" Devices

1. Remove the 5.25" drive trays from the storage module.
2. Remove the screws and drive tray brackets from the drive trays.
3. Install the 5.25" devices into storage module.
4. Replace the module back into the chassis.
5. Ensure that the storage module is securely locked into position.

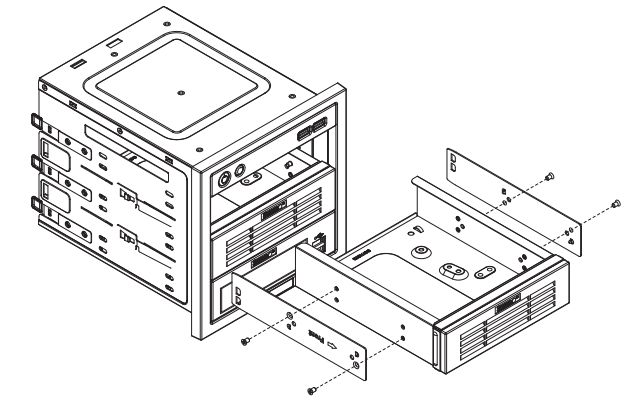

Hard Drives Installation

Installing 2.5" Drive into the Converter Tray

1. The 2.5" drives feature a toolless installation method.
2. Fit one side of the drive against the release lever.
3. Press the other side of the drive down until it clicks into place.

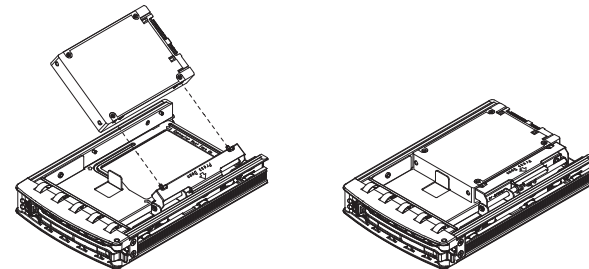

Installing 3.5" Hard Drives

1. Remove the screws from the drive carrier.
2. Install the 3.5" drive into the drive carrier and reinstall the screws

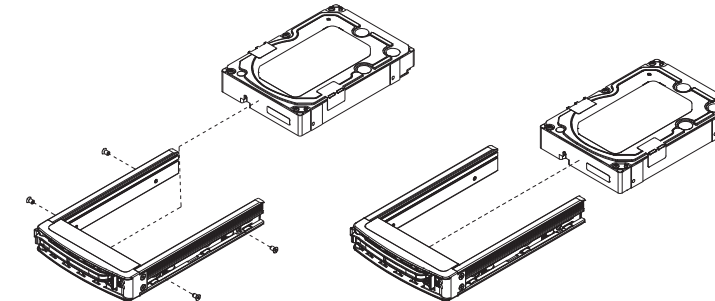

CPU Installation

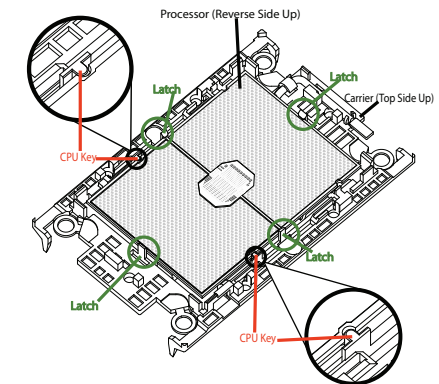

Heatsink Installation

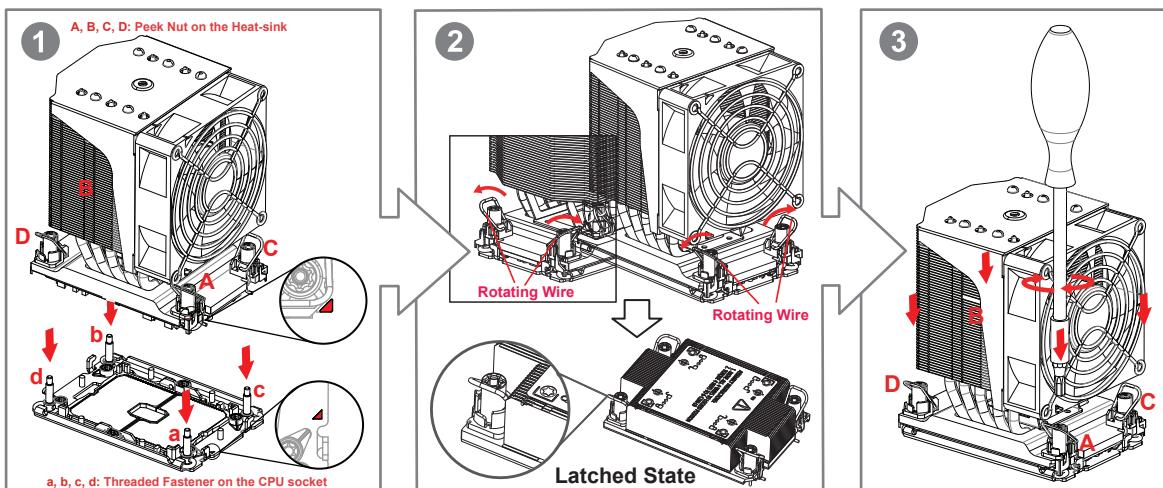

Installing Heatsink

1. Tighten the screws in the sequence of A - B - C - D, making sure that each peek nut is properly attached to its corresponding threaded fastener.
2. Press all four rotating wires outwards and make sure that the heatsink is securely latched onto the CPU socket.
3. Mount the fan module onto the Heatsink Module (direction of the arrow on the fan module should be pointing towards the rear of the chassis)

Caution

SAFETY INFORMATION
IMPORTANT: See installation instructions and safety warning before connecting system to power supply.
http://www.supermicro.com/about/policies/safety_information.cfm

WARNING:
To reduce risk of electric shock/damage to equipment, disconnect power from server by disconnecting all power cords from electrical outlets.
If any CPU socket empty, install protective plastic CPU cap

CAUTION:
Always be sure all power supplies for this system have the same power output. If mixed power supplies are installed, the system will not operate.

For more information go to :
<http://www.supermicro.com/support>

