

# SUPERMICR<sup>®</sup> SuperWorkstation 5038D-I Quick Reference Guide

## Board Layout

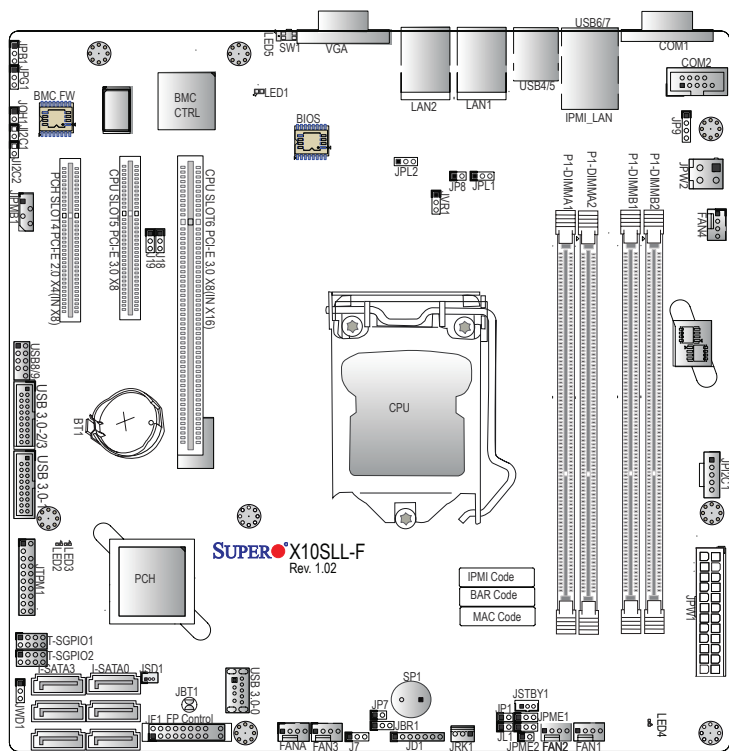

COM1/COM2	COM1/COM2 Port Headers
Fan1-Fan4, FanA	System/CPU Fan Headers
JF1	Front Panel Control Header
JIPMB1	4-pin External BMC I/O Header (for an IPMI Card)
JSD1	SATA DOM (Device_On_Module) Power Connector
JTPM1	Trusted Platform Module/Port 80 Connector
(IPMI)_LAN (for -F Models)	IPMI_Dedicated Gigabit (RJ45) Port
I-SATA0-1-SATA5	(Intel PCH) Serial ATA (SATA 3.0/2.0) Ports 0-5
(CPU)Slot 6	PCI-Express 3.0 x16 Slot (x8 if Slot 4 is used)
(CPU)Slot 5	PCI-Express 3.0 x8
(CPU)Slot 4	PCI-Express 3.0 x8 in x16 Slot
USB 3.0-0 (USB0)	Front Accessible Vertical USB 3.0 Type A Header
USB 3.0-2/3 (USB2/3)	Front Panel Accessible USB 3.0 Headers 2/3 (for X10SLM-F Only)
USB 8/9	Front Panel Accessible USB 2.0 Headers 8/9

## DIMM Memory Installation

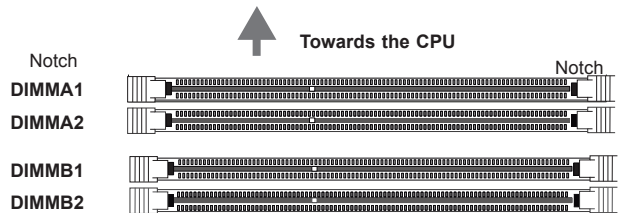

### Memory Population Guidelines

When installing memory modules, the DIMM slots should be populated in the following order: DIMMA2, DIMMB2, then DIMMA1, DIMMB1.

- Always use DDR3 DIMM modules of the same size, type and speed.
- Mixed DIMM speeds can be installed. However, all DIMMs will run at the speed of the slowest DIMM.

Recommended Population (Balanced)				
DIMMA2	DIMMB2	DIMMA1	DIMMB1	Total System Memory
1GB	1GB			2GB
1GB	1GB	1GB	1GB	4GB
2GB	2GB			4GB
2GB	2GB	2GB	2GB	8GB
4GB	4GB			8GB
4GB	4GB	4GB	4GB	16GB
8GB	8GB			16GB
8GB	8GB	8GB	8GB	32GB

**Note:** Up to 32GB of memory are supported. See chapter 2 of the User Manual for complete memory population information.

## Front View & Interface

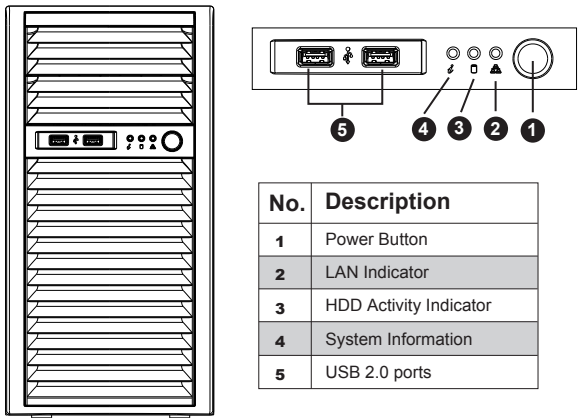

## CPU Installation

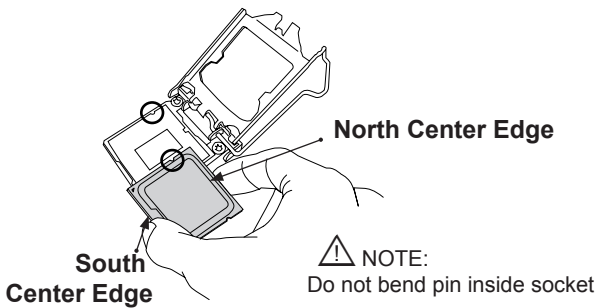

## Hard Drives Installation

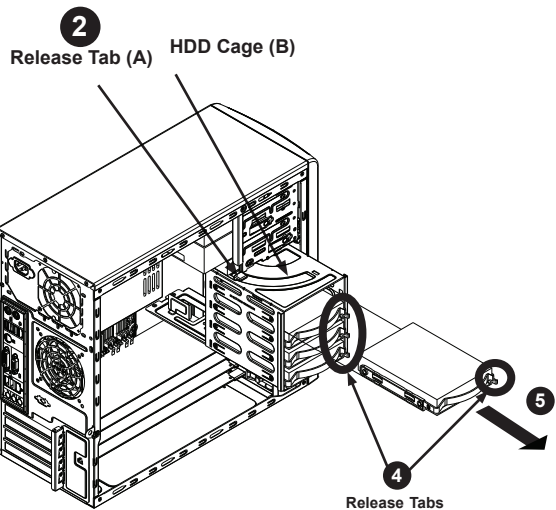

### Removing and Installing 3.5" Hard Drives

- Disconnect the chassis from any power source.
- Rotate the hard drive cage outward 90 degrees.
- Disconnect all of the cables from the hard drive.
- Press the release tab on the side of the hard drive carrier that is to be removed from the hard drive cage.
- Gently slide the hard drive carrier out of the hard drive cage.

## Installing an Optical Device

### Installing an Optical Device

- Remove the front bezel from the chassis by lifting it upwards from the bottom, and pulling off the front of the chassis.
- Remove the cover plate from the optical device slot on the front of the chassis.
- Install the bracket rail (A) onto one side of the optical device, by inserting the pins of the bracket into the mounting holes on the sides of the optical device.
- Slide the optical device into the chassis.
- If desired, screws may be used where indicated below (B) to secure the optical device into chassis.

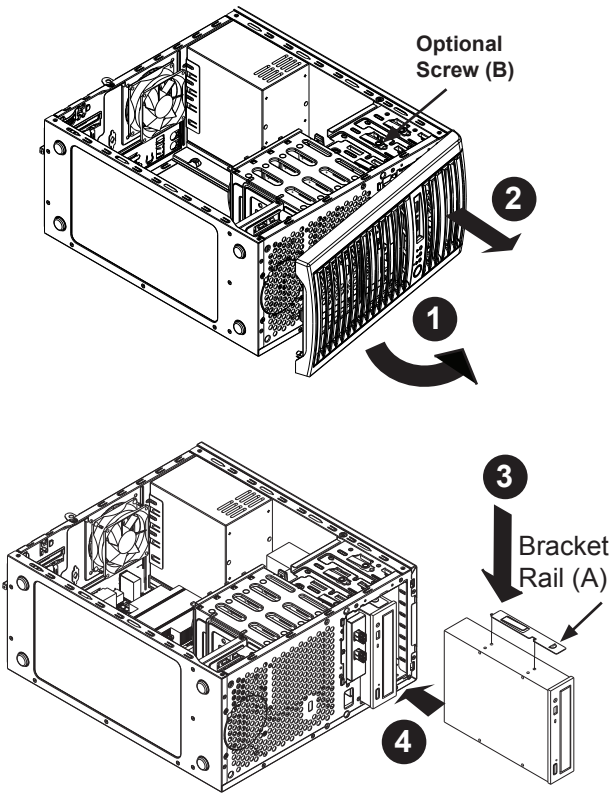

## Caution

**SAFETY INFORMATION**  
IMPORTANT: See installation instructions and safety warning before connecting system to power supply.  
[http://www.supermicro.com/about/policies/safety\\_information.cfm](http://www.supermicro.com/about/policies/safety_information.cfm)

**WARNING:**  
To reduce risk of electric shock/damage to equipment, disconnect power from server by disconnecting all power cords from electrical outlets.  
If any CPU socket empty, install protective plastic CPU cap

**CAUTION:**  
Always be sure all power supplies for this system have the same power output. If mixed power supplies are installed, the system will not operate.

For more information go to <http://www.supermicro.com/support>

## Heatsink Installation

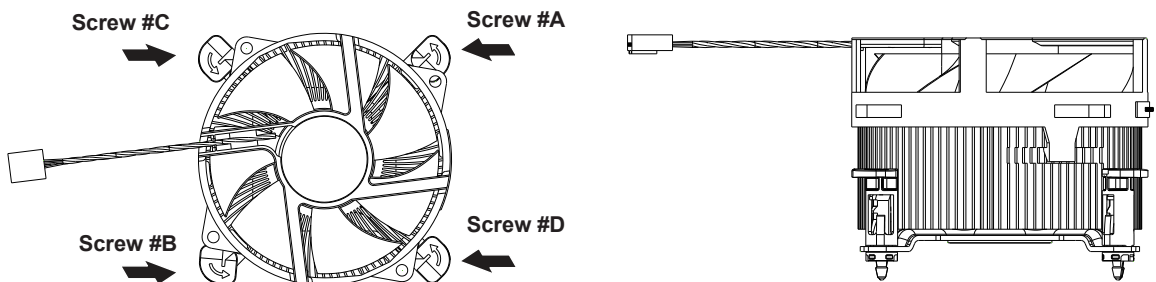

- Note:**
- Place heatsink on top of installed CPU
  - Line up the four screws to socket
  - Push down heatsink and screw as shown (cross pattern, in order: A, C, B, D)

